



FICHA TÉCNICA

Producto: **Bloque de Cadena Total Tools**

DESCRIPCIÓN: Bloque de Cadena Total Tools soporta una carga de 2 toneladas, hasta una altura de 3 metros. De un peso de 12.5 Kg. con 2 cadenas.

CÓDIGO: THT1621



Marca: Total Tools

Carga: 2 t (toneladas)

Altura: 3 m

Peso: 12.5 Kg.

Numero de Cadenas: 2

Procedencia: Importado

TOTAL

One-Stop Tools Station

TOTAL

CHAIN BLOCK

THT1611

THT1621

THT1631

THT1651

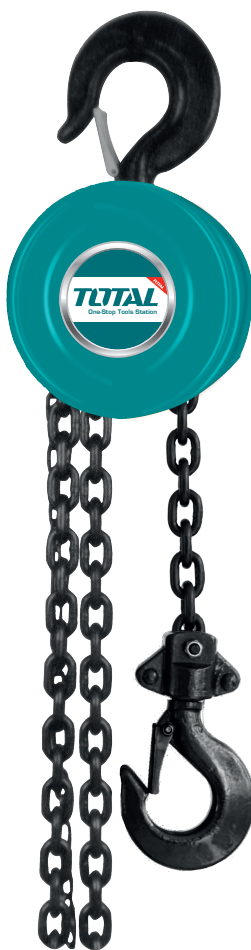

INDUSTRIAL



CE



CHAIN BLOCK

OPERATION INSTRUCTIONS

1. Judge the weight of the load to be lifted and make sure if the weight is over the rated capacity of the chain block. Never overload the block on any occasion.

2. Careful inspection should be made to the parts, such as hooks load chain, hauling device, etc, and the lubrication of the block. The chain block can only be put into operation when it is found to be in good condition.

3. Before lifting, inspect the hooks to see whether they are securely attached. Obliquity of the hooks and load suspension at hook tip are not permissible. For perfect performance of the block, the load chain should be kept vertically straight without and twist so as to prevent it from tangling.

4. During operation, the operator should stand in the plane of the handwheel (9) To lift the load, pull the hand chain (15) to rotate the handwheel in clockwise direction. When pulling the hand chain in the reverse direction, the handwheel will be separated from brake seat (10), the ratchet disc (14) checked by pawl (17) will be released, and the load will be lowered down smoothly.

Do not pull the hand chain in a position oblique to the plane of the handwheel to prevent tangling of the hand chain and turning of the block.

5. For the sake of safety passing or working under a lifting load is strictly forbidden.

6. While lifting or lowering a load, the hand chain should be pulled steadily so as to prevent it from jerking or tangling.

7. Stop operation immediately in case the hand chain cannot be pulled any further. Don't ask more hands for pulling. proceed inspection as follows;

(1) If there is anything entangled with the load.

(2) Whether there is any trouble with the parts of the block.

(3) Whether the load weight is over the rated capacity of the block.

MAINTENANCE

1. Clean off the dirt on the chain block after use and store it in a dry place to keep it from getting rusty and corrosive.

2. Clean the parts with kerosene and smear the gears and bearings with grease once a year by a skilled hand.

3. Align the "0" marks of the two gears (8) while assembling, as shown in Section View CC.

4. The rollers (12) of the chain sprocket bearing may be stuck with grease to the journal of the chain sprocket (4) before fitting them into the outer race of the bearing (13) on the side plate.

5. While assembling the brake mechanism, care should be taken to mesh the slanting teeth of the ratchet disc and the pawl. Make sure that the pawl is controlled by the spring sensitively and reliably. Then turn the hand wheel clockwise after screwing it onto the driving shaft, and it must press the disc and the plates on the brake seat. Turning it counterclockwise, there should be clearances between the disc and plates.

6. Transition fit is applied to the stay (3) and the right side plate (2). Don't dismantle them, or they will get loose.

7. Never allow any layman to disassemble the block.

8. After cleaning and repairing the block should be subjected to no-load test and heavy load test. A chain block can be put into operation after it has been tested and found in good condition.

9. Keep clean the friction surfaces of the brake while lubricating or operating the block. Brake mechanism should be inspected regularly for prevention of faulty braking and falling of the load

SPECIFICATIONS

Model		THT1611	THT1621	THT1631	THT1651
Capacity	t	1	2	3	5
Standard Lift	m	3	3	3	3
Him	mm	300	380	470	600
Effort force	N	322.5	345	404	476
Load chain falls		1	2	2	2
Load chain		mm	Ø 6x18	Ø 6x18	Ø 8x24
Dimensions (mm)	A	142	142	178	210
	B	122	122	139	162
	C	28	34	38	41
	D	142	142	178	210
Net Weight		kg	9.5	13.5	21.5

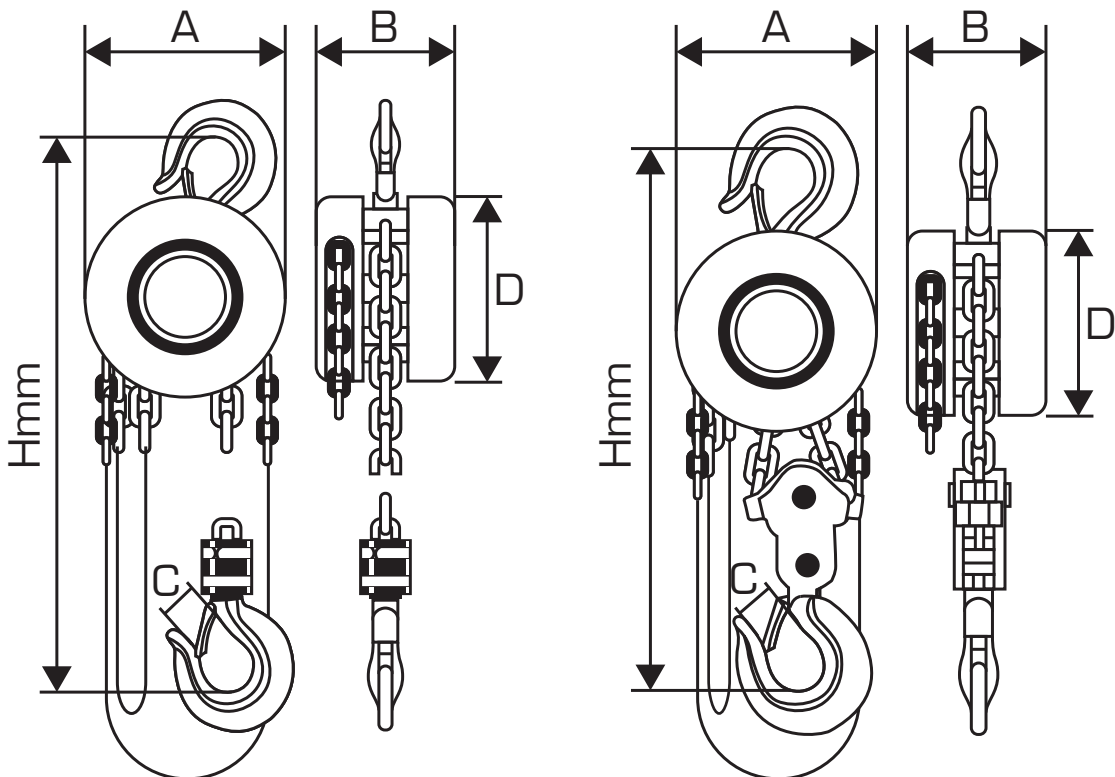

THT1611,THT1621,THT1631,THT1651 Spare part list

NO.	Description	NO.	Description	NO.	Description	NO.	Description
1	Load chain	11	Friction pleat	21	Left side plate	31	Bent plate
2	Right side plate	12	Roller	22	Suspension plate	32	Roller
3	Stay A	13	Bearing race	23	Suspension pin	33	Sheet cover
4	Chain Sprocket	14	Ratchet disc	24	Stripper	34	Shaft
5	Driving shaft	15	Hand-chain	25	Snap ring	35	Needle
6	Disk gear	16	Pawl spring	26	Pin	36	Ldle sheave
7	Pinion shaft	17	Pawl	27	Guild roller	37	Hookhanger
8	Disk gear	18	Hang wheel cover	28	Steel sheath	38	Hook
9	Hang wheel	19	Suap ring	29	Stay B	39	Latchkit
10	Baake seat	20	Pawl pin	30	Hookhanger	40	Double-spring

THT1611,THT1621,THT1631,THT1651 Exploding view

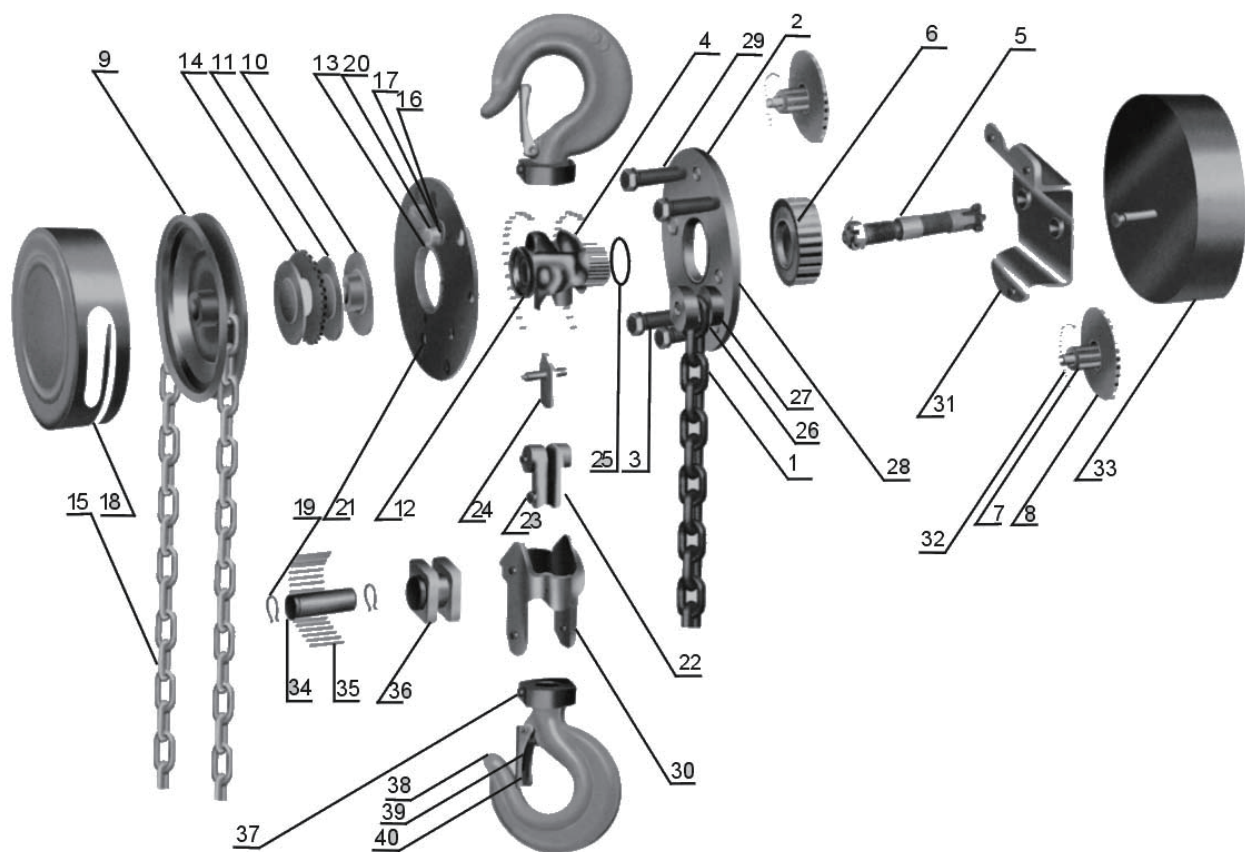

TOTAL

One-Stop Tools Station

TOTAL

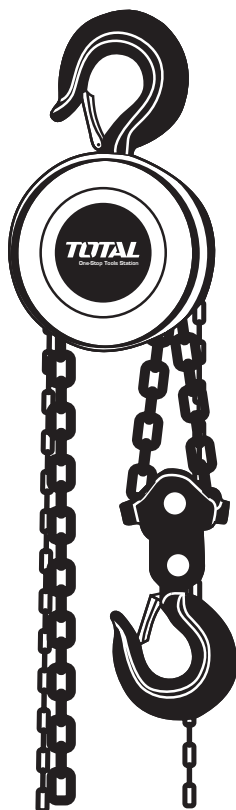

CHAIN BLOCK

www.totaltools.cn
TOTAL TOOLS CO., LIMITED
MADE IN CHINA
T0617.V03