

TYRE CHANGER
INSTRUCTION & MAINTENANCE MANUAL

We follow the way that wheel moving!



Read this entire manual carefully and completely
before installation or operation of the tire changer

TYRE CHANGER INSTRUCTION MANUAL

| INDEX | PAGE |
|--|-------------|
| 1. Introduction:..... | 2 |
| 2. Safety Warnings:..... | 2 |
| 3. Technical data | 3 |
| 4. Transport:..... | 3 |
| 5. Unpacking & Inspection: | 3 |
| 6. Workplace requirements: | 3 |
| 7. Position and installation:..... | 4 |
| 8. Electricity and Pneumatic connections: | 4 |
| 9. Adjusting operation:..... | 4 |
| 9.1. Breaking the tyre bead: | 5 |
| 9.2. Demounting the tyre : | 5 |
| 9.3. Mounting the tyre :..... | 6 |
| 10. Help Arm 086..... | 6 |
| 10.1. Technical Data | 6 |
| 10.2. Safety Regulations | 6 |
| 10.3. Installation | 6 |
| 10.3.1. Transport | 6 |
| 10.3.2. Unpacking..... | 6 |
| 10.3.3. Workplace Requirement..... | 6 |
| 10.3.4 Assembly..... | 7 |
| 10.4. Functional Parts | 7 |
| 10.5. Operations..... | 7 |
| 10.5.1. Fixing The Tire..... | 7 |
| 10.5.2. Demounting The Tire | 8 |
| 10.5.3. Mounting the tire..... | 8 |
| 11. Inflating the tire :..... | 9 |
| 12. Rapid tyre inflation system (only suitable for the IT-suffix version machine)..... | 9 |
| 12.1. Rapid Tire Inflation Device: | 9 |
| 12.2. Wheel rim lock and Tire inflation: | 9 |
| 12.3. Inflation for tire with inner tube:..... | 10 |
| 12.4. Inflation for tubeless tire: | 10 |
| 13. Moving machine: | 10 |
| 14. Maintenance:..... | 10 |
| 15. Trouble shooting table: | 12 |
| 16. Spare parts ordering guide | 12 |
| 17. Vulnerability consumable spare parts list | 13 |
| 18. Exploded drawing:..... | 14 |
| 19. Circuit diagram: | 25 |
| 20. Pneumatic drawing: | 25 |

Tyre Changer

Warning

This instruction manual is important for the machine, please read carefully before installation and use; also it is important for safe use and machine maintenance of machine. Please keep this manual properly in order to further maintenance of the machine.

1. Introduction:

Application Range: The automatic tyre changer is especially designed for demounting / mounting tyres from wheel rims.

Caution: Please use the machine only for purpose for which it is designed, don't use it for other purposes.

Manufacturer shall not be liable for any damage or injury caused by failure to comply with these regulations.

Safety regulation: Use of this machine is especially reserved to trained and qualified professional persons, those who already read the introduction manual carefully, or someone have the experience for operating similar machinery. Any changes and beyond the scope of use on this machine without manufacturer's permission or do not according to the manual, may cause the malfunction and damage to machine, manufacturer can cancel warranty coverage for above. If some parts are damaged due to some reason, please replace them according to the spare parts list. **(Attention: warranty is one year after manufactures' delivery date; warranty excludes the easy-broken parts).**

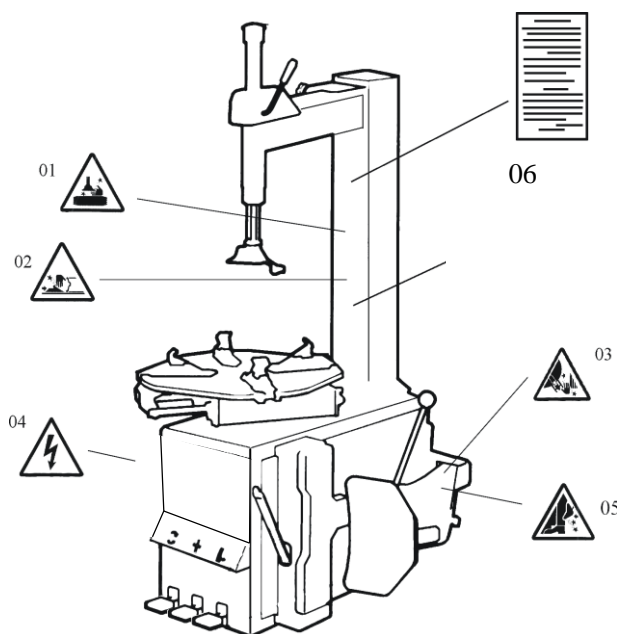

2. Safety Warnings:

- 01 Don't put hands under the Mounting head/demounting head during operation;
- 02 Don't put hands between the jaws during operation;
- 03 Don't put hands in the tyre bead when demounting the tyre;
- 04 Make sure and to check the system is equipped with a good grounding circuit;
- 05 Don't put feet between the Bead Breaker shovel and the body during operation;
- 06 Warning instruction

Security warning labels



Caution:

When the security warning labels are defaced or off, please recovery them in time!

Do not allow to operate when the security warning labels are missed or imperfect.

Do not allow to set any objects to obscure the security warning labels.

Clients can self-set the warning labels (as right picture show) at any necessary positions.

3. Technical data

| | |
|----------------------------------|------------------------------------|
| External locking rim dimensions | 12~26 " |
| Internal locking rim dimensions | 16~28 " |
| Max. Wheel diameter | 1143mm (45 ") |
| Max. Wheel width | 457mm(18 ") |
| Working Pressure | 8-10bar |
| Power supply | 110V (1ph)/ 220V (1ph)/ 380V (3ph) |
| Optional Motor power | 0.75/1.1 kw |
| Max. Rotating Torque (Turntable) | 1078 Nm |
| Overall Dimension | 1130*900*1050 mm |
| Noise Level | <75dB |

Remark:

Rim dimensions defined at above table are based on the iron wheel rims. Aluminum rims are thicker than the iron wheel rims, so here above rim dimensions are just for the reference.

4. Transport:

When transporting, the machine should be with original package and placed according to the mark on the package. For the already packaged machine should be handled with a corresponding tonnage forklift for loading and unloading. The location to insert the fork feet shown as **Fig 1**

5. Unpacking & Inspection:

Pull out the nail which is nailed on the plate with tip jaw; unpack the carton and plastic cover. Check and make sure all parts shown on the spare parts list are included. If any parts are missing or broken, please do not use the machine and contact the manufacturer or dealer ASAP.

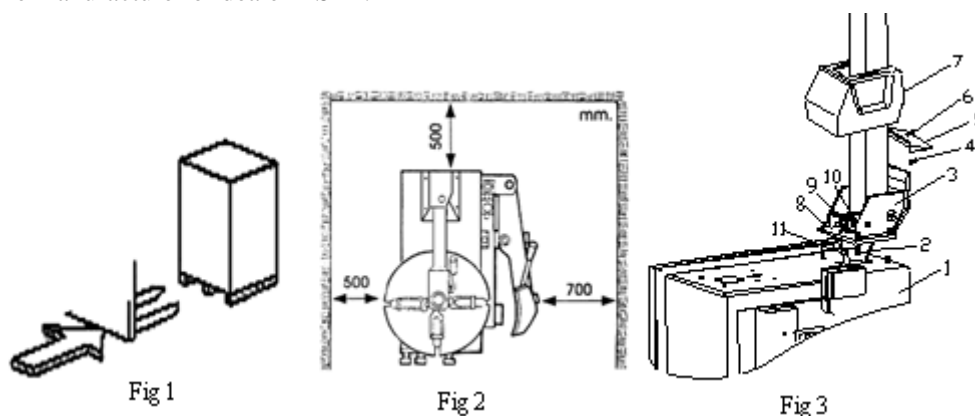

6. Workplace requirements:

Choose workplace in compliance with safety regulations. Connect power supply and air source according to manual and workplace must have good air condition; in order to make the machine run well, its workplace requires at least clear space from each wall shown as **Fig 2**. If installing it outdoor, it must be protected by roof against rain and sunshine.

Warning: the machine with motor must not be operated in explosive atmosphere.

7. Position and installation:

Install the column (accessories details refer to the exploded drawing)

- 1) Tools preparation
- 2) Place the tilting seat (3, Fig 3) on the body (1, Fig 3) with 4 bolts (M12), push air hose (2, Fig 3) through the hole of the column. Tighten 4 self-locking nut(8, Fig 3).
- 3) Insert screw (9, Fig 3) into the holes of both column and tilting cylinder shaft (11, Fig 3), tighten it with self-locking nut (10, Fig 3).
- 4) Unscrew the two bolts on the left cover and remove the cover, connect air hose (2, Fig 3) previously mentioned to the side holes which control the tilting 5-way valve. Fix the left cover.
- 5) Fix the plastic cover (7, Fig 3) with two bolts (4, Fig 3).
- 6) Mount the plastic back cover (5, Fig 3) on the column with screw (6, Fig 3).

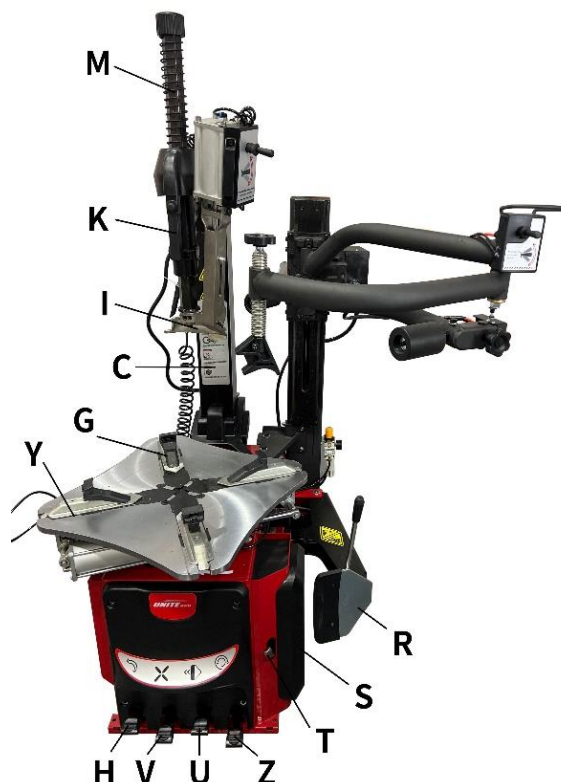

8. Electricity and Pneumatic connections:

Warning: Before installation and connection, check to be sure that the electricity power supply corresponds to the machine technical data. All the installation of electric and pneumatic devices must be operated by a professional electrician.

Connect the compressed air connector which is on the machine right side with compressed air system. The electric grid that the machine connects to must have fuses protection device and good outer cover grounding protection. Install the leakage automatic air switch on the main power supply, leakage current is set at 30A

Caution: No power plug for this machine, the user should self-connect one power plug no less than 16A as well as in line with the machine voltage. Or directly connect with the power supply according to the above requirements.

9. Adjusting operation:



Tilting pedal (H)



Turntable Rotation pedal (Z)

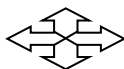

Jaws open and close pedal(V)

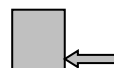

Bead Breaker pedal(U)



Rapid Tire Inflation Pedal(B)

- 1) Tread the Turntable Rotation Pedal (Z), Turntable (Y) clockwise rotation; Lift up the Turntable Rotation Pedal (Z), Turntable (Y) counterclockwise rotation.
- 2) Tread Bead Breaker Pedal (U), Bead Breaker shovel (F) close toward inside; release Bead Breaker Pedal (U), Bead Breaker shovel (F) return to original position.
- 3) Tread Jaws open and close Pedal (V), four jaws (G) on the turntable open; tread again, four jaws (G) close. When the pedal is in the middle position, the four jaws stop moving.

4) Tread Rapid Tyre Inflation Pedal (B), air flow out in a flash; release the pedal, the airflow stop. (Please read related warning and note, and be careful for the safety before debugging)

Tyre changer operation is consisted of three parts:

- 1) Breaking the tyre bead
- 2) Demounting the tyre
- 3) Mounting the tyre

Caution: Before any operations, don't wear loose clothing and wear protective hat, gloves, and skid-proof shoes. Ensure to exhaust the air in the tyre completely, and remove all the wheel weights from the rim.

9.1. Breaking the tyre bead:

Ensure to exhaust the air in the tyre completely, place the tyre against the rubber buffer (S). Bring the shovel (F) against the bead about 10mm from the edge of the rim shown as **Fig 5**. Depress Bead breaker Pedal (U) to push paddle into tyre. Repeat the above operations on different positions around the tyre and both sides of tyre until tyre bead is released completely.

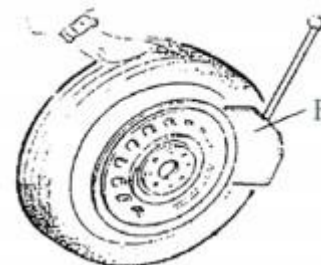

Fig 5

9.2. Demounting the tyre :

Ensure to remove all the weights on the wheel rim and to exhaust the air in the tyre completely before this operation. Apply lubricating grease (or similar lubricant) around the tyre bead. Without the lubricant may lead to badly wear and tear on tyre.

Clamp the wheel methods shown as below regarded to the ruled dimension:

a- to clamp the wheel from outside:

Depress the Jaws open and close Pedal (V) halfway down to middle, positioning for the four clamps (G) by reference scale on the Turntable (Y); put the tyre on turntable, hold the rim, and depress the Jaws open and close Pedal (V) until the wheel is secured by the jaws.

b- to clamp the wheel from inside:

Positioning for the four clamps (G) and let them all closed. Put the tyre on the turntable and depress the Jaws open and close Pedal (V) to open the clamps thereby lock the wheel in place.

Caution: Check to make sure the wheel firmly secured by the four clamps before next step.

Lower the Vertical Arm (M) until the Mounting head/demounting head (I) rests next to the edge of the rim, flip pneumatic locking button (K) to lock the Vertical Arm (M) and Horizontal arm in position, and control the distance from Mounting head/demounting head to the edge of wheel rim about 2-3 mm. Insert the Lifting Lever (T) between the tyre bead and the front section of the mounting head/demounting head (I), and move the tyre above the mounting head/demounting head as shown as **Fig 6**.

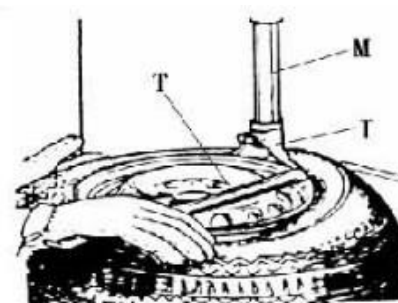

Fig 6

Caution: Chains, bracelets, loose clothes and anything else close to the rotating parts will bring danger to the operator.

With the Lifting Lever held in position, depress the Turntable Rotation Pedal (Z), rotate the Turntable (Y) in a clockwise direction until the tyre is completely separated from the wheel rim.

For the other side tyre demounting, keep using the lifting lever to lift the tyre, make the other side tyre separated from the wheel rim. Depress the Tiltting pedal (H), the column backward down, take out the tyre.

9.3. Mounting the tyre :

Caution: Check to make sure that the tyre and the wheel rim are of same size before mounting the tyre.

To avoid any damage on tyre, lubricate the tyre bead and the wheel rim with the lubrication recommended by manufacturer. Put on the tyre and check the situation.

Caution: When clamp the wheel rim, don't put your hands on the wheel rim to avoid injury during this operation.

Lock the Hexagonal Vertical Mounting Arm, put the tyre on the rim, let the Rocker Arm back to place as demounting the tyre.

And let one side of tyre down bead above the rear section of the Mounting head/demounting head, the other side under the front section of the Mounting head/demounting head. Suppress the tyre with hands or help arm, and then spin the turntable for mounting the tyre down bead.

Repeat the above operation for mounting the tyre up bead. (Fig 7)



Fig 7

10. Help Arm 086

The help arm 086 is an auxiliary device for tire changer, it is used to help to demount and mount tires.

Before any operation of this machine, the operator is requested to read the manual carefully. Do not attempt any operations that are not stated in it. Manufacturer will not be responsible for any injury or damage caused by improper operation. Please keep the manual handy for consulting.

10.1. Technical Data

| | |
|-------------------|----------------|
| Work Pressure | 8~10 bar |
| Weight | 100kg |
| Package dimension | 1550*310*550mm |
| Noise Level | LpA<75dB |



10.2. Safety Regulations

This device is especially reserved to trained professional personnel or somebody who has experiences on mechanical operation and read this manual carefully. This device must be used together with our tire changers, we are not sure it can work with others. Manufacturer won't be responsible for any unauthorized modification

10.3. Installation

Notice!

The installation of this auxiliary device should be done by professional personnel. Before assembly, disconnect the device from power supply and air source.

10.3.1. Transport

Move the device with a forklift truck as illustrated in Fig 8.

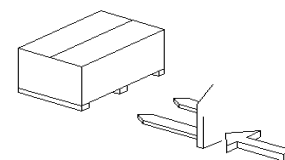

Fig 8

10.3.2. Unpacking

When unpacking, check and make sure all parts shown on the packing list are included. If any parts are missing or broken, please call the manufacturer or the dealer ASAP. Please keep the package out of children's reach.

10.3.3. Workplace Requirement

Fig 9 shows the minimum distance (cm) from walls after assembly this auxiliary device. Please choose the right place to install it.

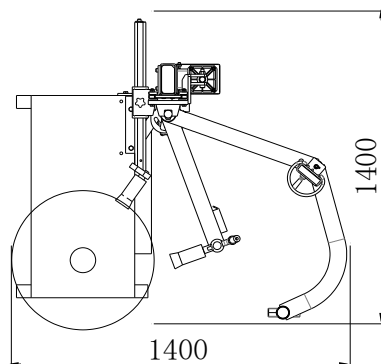

Fig 9

10.3.4 Assembly

- 1) Disconnect the tire changer from power supply and air source.
- 2) Fix the column on the body with four screw 1 and adjust the support 2 to a suitable location; (Fig 10)
- 3) Connect the air hose to the corresponding joint through the rear hole of the body.

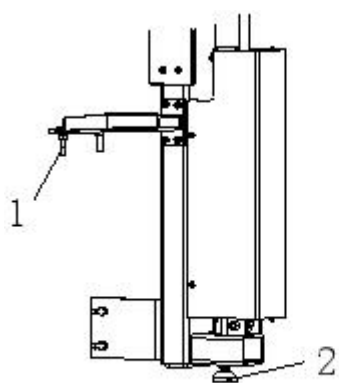

Fig 10↵

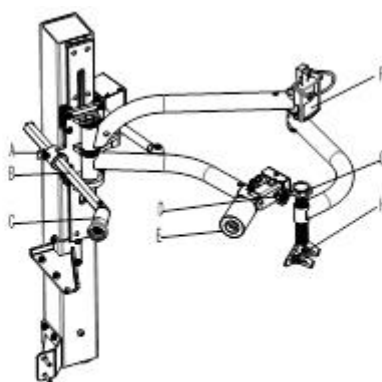

Fig 11↵

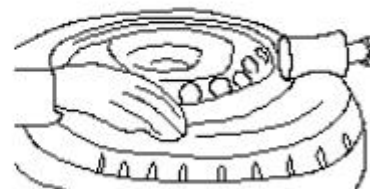

Fig 12↵

10.4. Functional Parts

Fig 11 shows functional parts to the 086 device:

- | | |
|--------------------------------|-----------------------------|
| A. Little adjust handle | B. Hexagonal horizontal arm |
| C. Tire lifting roller | D. Large adjust handle |
| E. Tire lifting roller support | F. Lifting switch |
| H. Adjustable threaded rod | |

10.5. Operations

Mounting and demounting big flat tire is difficult work. By the help of 086 help arm to mount/demount the tire from the tire bead will make the operation easier. It is a good helper for tire changer.

10.5.1. Fixing The Tire

Loosen the bead according to the manual. Clamp the tire from outside, tread the

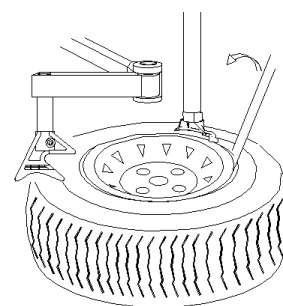

Fig 13

corresponding pedal to open the jaws;

Put the tire on the turntable; Tread the corresponding pedal to close the jaws until they near the rim.

10.5.2. Demounting The Tire

-1. Generally speaking, tire is very tight. Loosen the beads with the tire pressing head first (or using the bead breaker if it too tight to loosen).

Pull out the Hexagonal horizontal arm; let the tire pressing roller above the tire without collision.

Lower the tire pressing roller lower with the switch handle to press the tire. Tread the pedal to rotate the turntable. Loosen the bead during this procedure. **(Fig 12)**

Caution: Lubricate the tire pressing head (upper) and the bead before the operation.

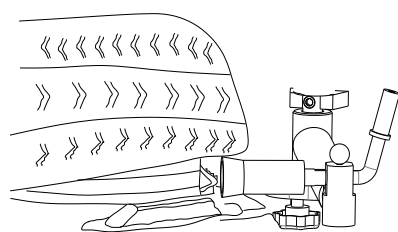

Fig 14

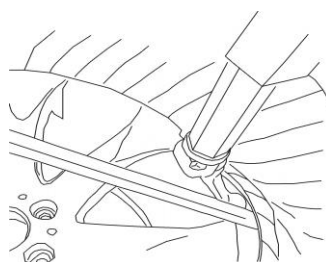

Fig 15

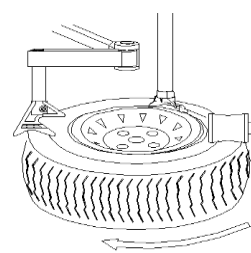

Fig 16

-2. Demounting the upper bead

a- Move the mounting head near the edge of the rim, rotate the tire pressing arm to move the tire pressing block above the tire, press the switch handle to depress the tire, and insert the lifting lever in the clearance between the tire and the rim, then hang the bead on the mounting head. (Fig14、 15)

b- Raise the auxiliary arm, rotate the tire pressing head to the opposite. Press the tire with the switch handle to create enough space.

c- Tread the power supply pedal to rotate the turntable. With the help of the tire pressing head, the upper tire bead is detached.

d- Raise the help arm to move the tire pressing block to its non-working position.

-3. Demounting the bottom bead

Turn the roller support and move it under the tire, but don't touch it with the rim.; (Fig 14) Tread the power supply pedal to rotate the turntable, meanwhile, lift help arm gradually to loosen tire and completely demount the bottom bead.

10.5.3. Mounting the tire

Lubricate the tire bead and rotate the turntable, mount the bottom bead with the mounting head; Pull the hex rod out, press the upper bead under the mounting head 5mm with the tire pressing roller, rotate the rotating arm and move the tire pressing block above the tire; Don't touch with the rim in the operation, or it causes damage on the rim due to friction.

Tread the power supply pedal to rotate the turntable and the tire pressing block, lower the help arm to press the tire

under the rim. Mount the tire with the mounting head. Please pay attention to the safety in the process of operation. (Fig 16)

11. Inflating the tire :

Importance: It is very dangerous during inflating operation, take carefully and comply with instruction. When inflating, it will turn to be extremely dangerous if problems happen to tyre or rim. The possible burst force tire goes upward and outward, the big power may cause injury or death of the operator or the people around.

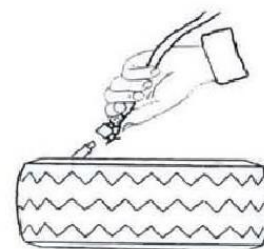

Fig 17

Tyre may burst caused by following:

- 1) The wheel rim and the tyre are not of the same size;
- 2) The tyre or the wheel rim is damaged;
- 3) The pressure of tyre inflation is over the max. pressure recommended by manufacturer;
- 4) The operator fail to comply with the safety regulation;

Please operate as follows:

- 1) Remove the valve cap from the valve stem;
- 2) Check to make sure the air nozzle is pressed down completely over the threads of the valve stem.
- 3) Check to make sure that the tyre and the wheel rim are of the same size;
- 4) Lubricate both the tyre bead and the wheel rim, additional lubrication is required if needed;
- 5) Inflate the tyre with break, while inflating, check the pressure listed on the pressure gauge, also check whether the bead is fixed or not. Repeat operation above until the bead is secured; you need take special steps when inflating convex rim or double convex rim;
- 6) Continue inflating and check the air pressure frequently until to reach the required pressure. (Fig 17)

Note: Never exceed the max. inflation pressure given by the tyre manufacturer.

Keep hands and your body away from inflating tyres.

Only specially trained persons are allowed to perform the operations, do not allow other to operate or be near the tyre changer.

12. Rapid tyre inflation system (only suitable for the IT-suffix version machine)

12.1. Rapid Tire Inflation Device:

Note: before inflating operation, please make sure the pneumatic power supply connect well.

Before operation, must check the devices perform well as follow:

- a. Press Rapid Tire Inflation Pedal to the middle position (Fig 36, position 1), the inflating head should give air.
- b. Press Rapid Tire Inflation Pedal all the way down (Fig 36, position 2), a strong air blast should come from the holes in the four jaws' locking sliders. (Fig 37)

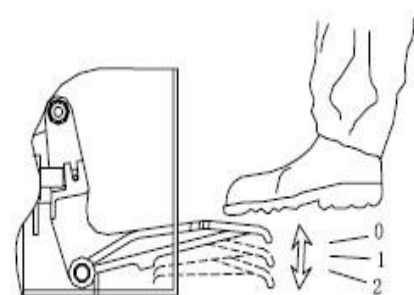

Fig 36

12.2. Wheel rim lock and Tire inflation:

Note: A wheel can explode if:

- 1). the diameter of the rim is not exactly the same at the tyre's.
- 2). the rim or tyre are defective.
- 3). the tyre is inflated to a pressure higher than the maximum recommended by the manufacturer.
- 4). the operator does not observe the requisite safety regulations.

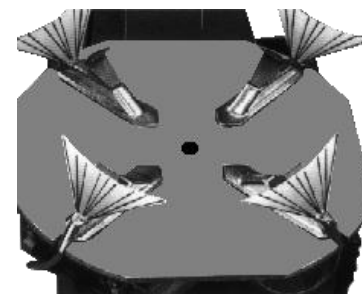

Fig 37

12.3. Inflation for tire with inner tube:

- 1). Remove the valve stem.
- 2). Check to be certain that tyre and rim diameter correspond.
- 3). Check to be certain that rim and beads are sufficiently lubricated.
- 4). Press the pedal down to the middle position to start inflation.
- 5). Release frequently the inflating pedal to check pressure on the manometer. If the air pressure is too high, press the button under the manometer for release the rest air until the correct pressure is reached.

12.4. Inflation for tubeless tire:

Note: When inflating tubeless tire using a strong jet of air, the wheel must be clamped from the inside of the rim.

- 1). Remove the valve stem.
- 2). Check to be certain that tire and rim diameter correspond.
- 3). Check to be certain that rim and beads are sufficiently lubricated.
- 4). Press the pedal down to the middle position to start inflation.
- 5). If the bead of the tyre is not well seated, due to a strong bead, lift tyre manually until the upper bead seals against the rim, then press the pedal all the way down. A strong jet of air will be released through the nozzles in the slides and this will help the bead seal.
- 6). Release the tyre, set the pedal back to the middle position and continue to inflate the tyre to the required pressure. If the air pressure is too high, press the button under the manometer for release the rest air until the correct pressure is reached.

Note:

- 1). **Failure to follow all warnings and instructions may lead to serious personal injury or death to operator or bystander. NEVER exceed 3.5 bar (50 psi) when seating beads or inflating tyres.**
- 2). **If a higher tire inflation pressure is required, remove the wheel from the tyre changer and continue the inflation procedure with the wheel inside a special protection cage. NEVER exceed the maximum inflation pressure given by the tyre manufacturer.**
- 3). **Only specially trained persons are allowed to perform these operations. Do not allow others to operate or be near to the tyre changer.**

13. Moving machine:

Please use forklift to move the machine. Disconnect the tyre changer from the electricity power supply and pneumatic power supply, lift the base board and insert the feet of forklift. Then mount the tyre changer machine to a new position and fix it tightly.

Note: the place chosen for fixing the tyre changer must meet the safety regulation.

14. Maintenance:

Caution: only the professional persons can do the maintenance. To prolong the machine's life, maintain the machine timely according to the manual. Otherwise, it will impact the reliability of the machine or even cause injury to operator and others nearby.

Caution: before performing any maintenance, disconnect the tyre changer from the electric power supply and pneumatic power supply, and depress the Jaws open and close Pedal or Turntable Rotation Pedal for 3~4 times to evacuate all compressed air from the machine. Damaged parts must be replaced by professional persons with the spare parts provided by manufacturer.

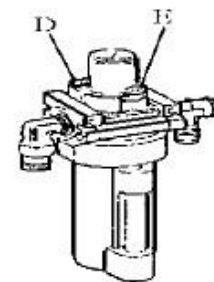
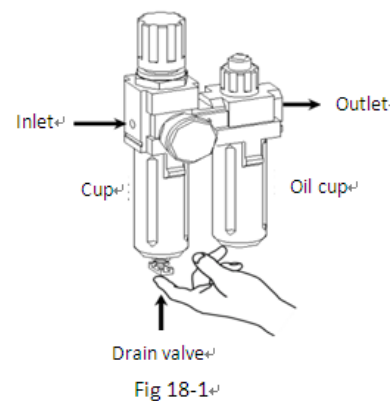

Fig 18

- Clean the machine once every day after work. Clean the dirt on the turntable with diesel oil once per week and lubricate the slides and clamps.

- Following maintenance must be done at least once per month:
 Check oil level in Oil Fog Maker, please be filled with SAE30# oil if need.
 Unscrew with hex wrench (E). Based on connection of compressed air, first to depress Jaws open and close Pedal or Turntable Rotation Pedal 5-6 times, and then check whether oil in Oil Fog Maker drops down a drip of oil. For continuous operation, depress twice every time, drop down a drip of oil, otherwise adjust the screw (D) that controlled oil enter with minus screwdriver. (Fig 18)



- As shown in Figure 18-1, when you found there are some water in the cup, push up the drain valve to drain away water with your fingers; loosen your fingers after drained water, drain valve can be automatic closed under the action of the spring.

Note: After the first 20 days of use, retighten the jaws with tightening screws (B) on the Turntable (Fig 19)

Note: in the event of turntable lose power, check to see if the belt is tight as follow steps:

Remove the left side cover by unscrewing the screws; adjust two screws located on the motor support, keep a suitable distance between motor support and motor base; tight the screws for the belt tension.(Fig 20)

Caution: please disconnect the machine from electric power supply and pneumatic power supply.

Note: If Vertical Arm not be locked or not meet the requirement that 2-3mm from the bottom of Mounting head/demounting head to rim, please adjust Hexagonal Locking Plate, refer to Fig 21 and adjust the (X).

Note: In order to achieve the reliability of jaws and Bead Breaker shovel, operate as follows to keep their valves clean:

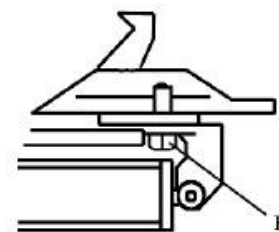

Fig 19

1. Remove the left side cover of the machine body by unscrewing the two screws;
2. Loosen the valve mufflers (A) which belong to Jaws open and close Pedal and Bead Breaker Pedal;
3. Clean the mufflers with compressed air, please replace it referring to the spare parts list if it is damaged. (Fig 22)

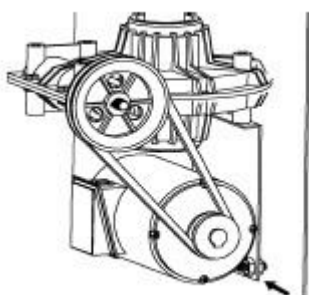

Fig 20

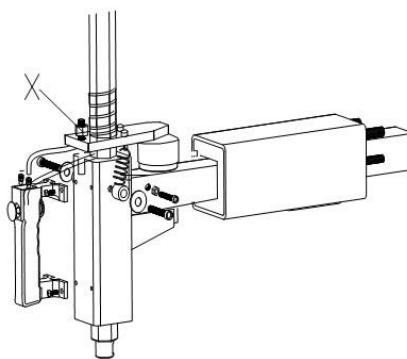

Fig 21

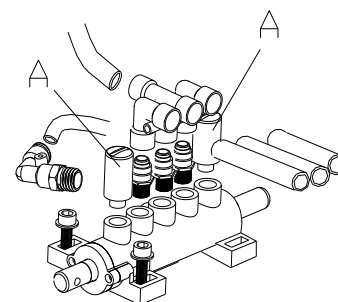

Fig 22

15. Trouble shooting table:

| Problem | Reason | Solution |
|--|--|--|
| The turntable rotate just in one direction or can't rotate. | Reverse Switch broken | Replace the Reverse Switch |
| | Belt broken | Replace the belt |
| | The Motor's malfunction | Check the motor cable or terminal block wire; Replace the motor if it was broken. |
| Demount or fix the wheel, the turntable can't lock (spin with wheel); The jaws delay to open/close; The turntable locks the rim incorrectly. | Leakage of Air network | Check all the parts on the air network. |
| | The clamping cylinder can't work. | Replace the cylinder piston. |
| | Worn jaws | Replace the jaws. |
| | Broken washers of the chuck cylinder | Replace it. |
| The mounting head/demounting head always touch the rim during operation. | The locking plate incorrectly adjust or unqualified. | Replace or adjust it. |
| | Screws on the chuck loose; the Vertical Arm can't be locked by Locking Plate | Tighten the screws; replace the Locking Plate. |
| The Bead Breaker Pedal and Jaw open and close Pedal can't turn back to the original position. | pedal spring broken | Replace it. |
| The Bead Breaker shovel operates difficultly. | Jammed silencer | Clean it or replace it. |
| | The washer on the Bead Breaker cylinder is broken. | Replace it. |

16.Spare parts ordering guide

- 1、 First get the damaged or the product samples which have to stock up, and confirm the quantity of parts.
- 2、 In order to avoid the mistakes, confirm the specification of the parts which need to replace.

Confirmation as follows: According to the using range and position of the parts, find the corresponding code from the exploded drawing and record the full code(section 16).For the customers with many models, if the same accessories in

Different models, the ERP information coding shows different serial number, for example, lifting lever: the ERP information coding is C-200-580000-0,the series number in different models,shows12.200-12 or other forms of series number, that belong to the same accessories. So full in the list can be classified into the spare parts category.

For example, we need to buy crow bar, because crow bar always placed in crow bar set inside, so we locate the exploded drawing as below:

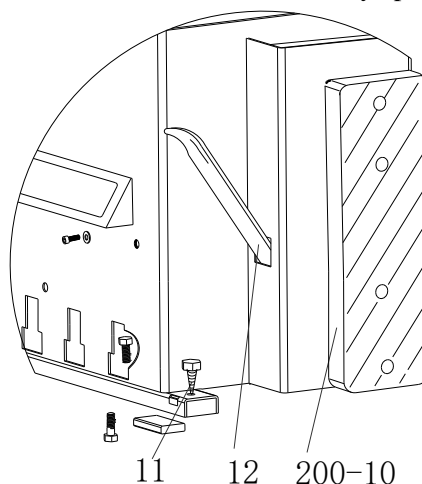

See number “12” from the figure, then find all the messages from the list ,and record it.
As the following figure

| | | |
|--------|---------------|-----------------------|
| 11 | FJ04006004049 | Grounding screw M6x40 |
| 12 | JZ09001023041 | Lifting lever |
| 200-10 | JZ09001050330 | Bead breaker buffer |

Record the information

| | | |
|----|---------------|---------------|
| 12 | JZ09001023041 | Lifting lever |
|----|---------------|---------------|

3、 Collect the details information of the products

For example

| NO. | Order number | Name | Quantity | Buy time |
|-----|---------------|---------------|----------|-----------|
| 12 | JZ09001023041 | Lifting lever | 2 | 2009.6.25 |
| | | | | |

4、 Contact our spare parts department to confirm the order information.

5、 Confirm the order information are correct, then according to the order of supply and demand information delivery to you timely

Special announcement

- ◆ The company reserves the right to change the parts specifications without prior notice.
- ◆ The company Modified and improved the products, but don't have the obligation to the products which had out of the factory.

17.Vulnerability consumable spare parts list

| Query NO. | Order NO. | Parts name | Query NO. | Order NO. | Parts name |
|-----------|---------------|------------------------------|-----------|---------------|-----------------------------|
| 256-4 | JZ09001050330 | Bead breaker buffer U256P | 363 | FJ08005005395 | Y-seal ring Φ184*Φ200*12 |
| 226 | FJ08003005391 | V-seal ring Φ20*Φ28*7.5 | 228-365 | FJ08001005135 | O-seal Ø170.8*5.33 |
| 227 | FJ08001005319 | O- seal 68*3.55 | 200-426 | DD03009001577 | Reverse switch LW8-25N2/5.5 |
| 200-228 | JZ09001022765 | Clamping cylinder piston Ø75 | 521 | FJ08001005221 | O-seal ring Φ30*3.55 |
| 232 | FJ08001005151 | O-seal ring Φ19.6*2.62 | 200-532 | FJ08001005300 | O-seal ring Φ59.99*2.62 |
| 306 | FJ08001005120 | O-seal ring Φ16*2.65 | 604 | FJ02003003545 | Balancer Belt A-686 |
| 307 | FJ08001005151 | O-seal Ø 19.6*2.62 | 811 | EQ03001002902 | Filter AW+AL3300 |
| 228-362 | FJ08001005153 | O-seal ring Φ195*3.1 | | | |

Remark: The parts in this list are vulnerability consumable spare parts , if you have other parts order please query the accessories instruction manual.

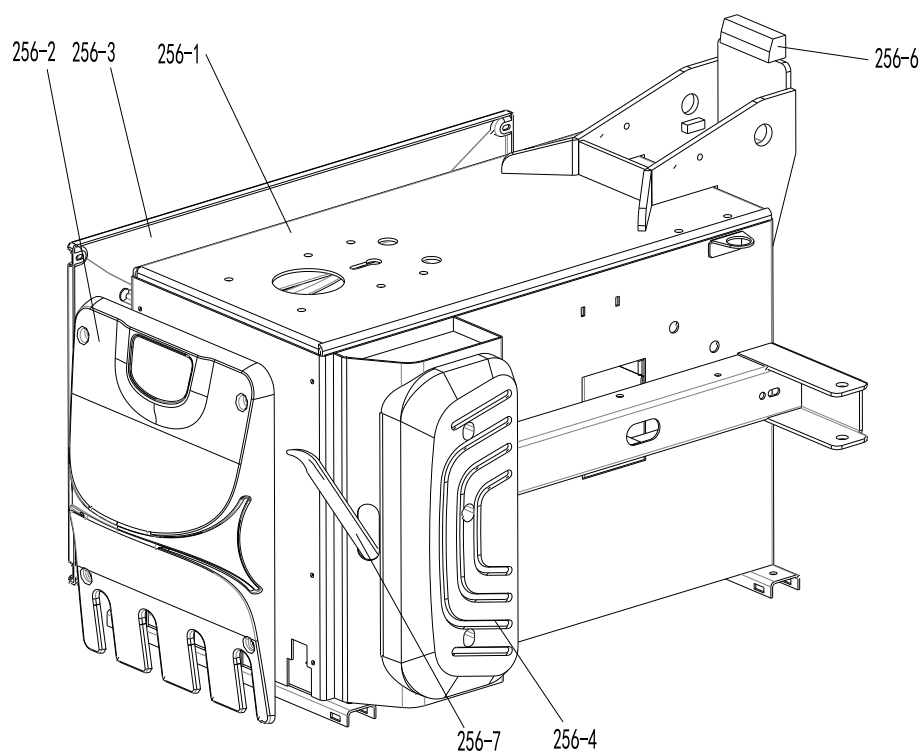
18. Exploded drawing:

| | | |
|-------|---------------|-----------------------|
| 256-1 | JZ08001050302 | Machine body 256P |
| 256-2 | JZ09001049789 | Pedal front cover |
| 256-3 | JZ08001021147 | Left cover |
| 256-4 | JZ09001050330 | Bead breaker buffer |
| 256-6 | JZ09001022761 | Tilting protect cover |
| 256-7 | JZ09001023040 | Lifting lever |

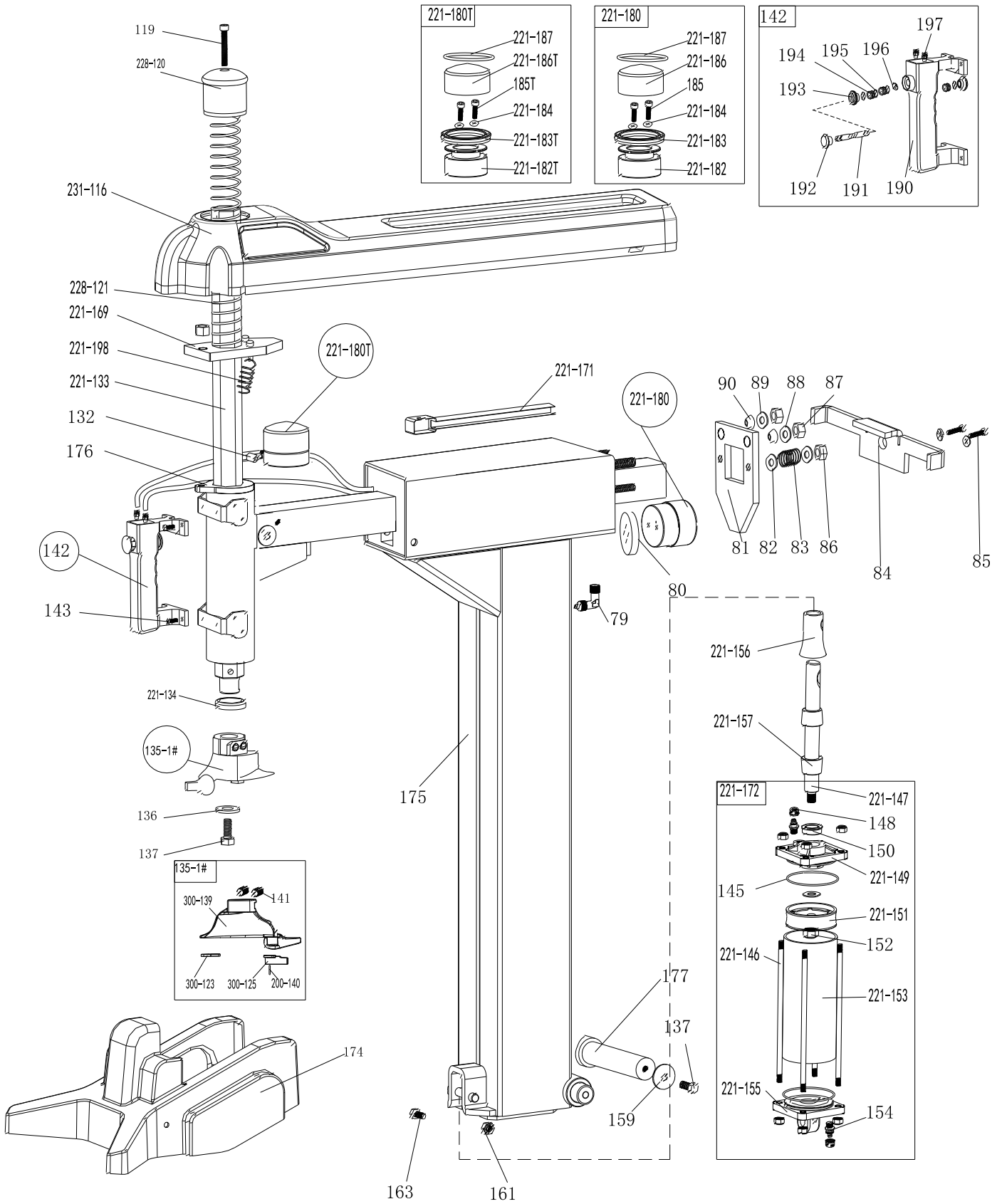

| | | | | | |
|----------|---------------|--|----------|---------------|---|
| 79 | EQ10004003262 | Quick coupler G1/8-Φ6 | 221-146 | JZ09001022769 | Tilting cylinder threaded |
| 80 | JZ07001020906 | Locking cylinder plate Φ60*10 | 221-147 | JZ09001022767 | Tilting cylinder piston rod |
| 81 | JZ03001015520 | Horizontal arm locking plate | 148 | FJ04008004459 | Nut M8 |
| 82 | FJ04002003904 | Flat washer 8*17*1.5 | 221-149 | JZ09001022762 | Tilting cylinder cover without handle |
| 83 | JZ09001022819 | Horizontal arm locking spring | 150 | FJ08003005391 | V-seal ring Φ20*Φ28*7.5 |
| 84 | JZ03001040604 | Horizontal arm block G23 | 221-151 | JZ09001022765 | Tilting cylinder piston ALU Φ75 |
| 85 | FJ04009004877 | Outer hex bolt M8*20 | 152 | FJ04008004495 | Nut M12*1.75*T6 |
| 86 | FJ04008004459 | Nut M8 | 221-153 | JZ09001022770 | Tilting cylinder barrel φ75*130 |
| 87 | FJ04008004445 | Nut M12 | 154 | EQ10005003297 | Quick coupler G1/8-Φ6 |
| 88 | FJ04002003813 | Flat washer 12*24*2 | 221-155 | JZ09001022763 | Tilting cylinder cover with handle |
| 89 | FJ04002003813 | Flat washer 12*24*2 | 221-156 | JZ09001015545 | Tilting cylinder piston rod cover U221 |
| 90 | JZ09001023102 | Locking spacer U221 | 221-157 | JZ09001022771 | Tilting cylinder rubber sheath1 40*36*40 |
| 231-116 | JZ09001040607 | Horizontal arm protection cover G23 | 159 | FJ04002003806 | Flat washer 10*40*3 |
| 119 | FJ04009004588 | Hex socket head cap screw M10*50 | 161 | FJ04008004445 | Nut M12 |
| 228-120 | JZ07001020884 | Vertical arm cap 228 U228 | 163 | FJ04009004806 | Outer hex bolt M12*65 |
| 228-121 | JZ09001022980 | Vertical arm spring U228 Φ3*730 | 221-169 | JZ03001015648 | Hex locking board 221 |
| 128 | JZ09001023148 | Shock absorber U221 | 231-171 | JZ07001020901 | Hose guide U221 |
| 129 | FJ04009004686 | Hex socket head cap screw M6*35 | 221-172 | JZ06001020238 | Complete tilting cylinder U-221 |
| 221-130 | JZ07002020942 | Pulley U120 | 174 | JZ09001040608 | Column protection cover G23 |
| 131 | FJ04009004676 | Hex socket head cap screw M6*16 | 175 | JZ08001021071 | Column U731 |
| 132 | EQ11002003339 | Quick coupler G1/8-2*Φ6 | 176 | FJ04006004255 | screw M5*16 |
| 221-133 | JZ03001015899 | Vertical arm S41 | 177 | JZ03001049971 | Column shaft U731 |
| 221-134 | JZ09001022968 | Vertical arm washer S41 | 221-180 | JZ06001020239 | Complete locking cylinder,L-union |
| 300-123 | JZ07001048476 | Mount/demount head flat protector 1# | 221-180T | JZ06001044758 | Complete locking cylinder,T-union |
| 300-125 | JZ07001048477 | Protector Mount/demount head 1# | 221-182 | JZ09001023098 | Locking cylinder piston U221 |
| 135-1# | JZ06001048884 | Complete mount/demount head-spec with protector | 221-183 | FJ08003005389 | V-seal ring Φ50*Φ60*6.5 |
| 136 | JZ03001015342 | Mount/demount head flat washer U200 | 221-184 | FJ08001005285 | O-seal ring Φ5.5*2.5 |
| 137 | FJ04009004770 | Outer hex bolt M10*25 | 185 | FJ04009004689 | hex socket head cap screw M6*55 |
| 300-139 | JZ09001022699 | Mount/demount head-spec. 1# | 221-186 | JZ03001015728 | Locking cylinder cover U221 |
| 200-140 | JZ09001022993 | Hex round pin U200 | 221-187 | FJ08001005293 | O-seal ring Φ52*2 |
| 141 | FJ04006004130 | Screw M12*16 | 190 | JZ07001020898 | Pneumatic handle switch plate |
| 142 | JZ06001020331 | Complete Pneumatic locking switch U-221 | 191 | JZ09001015680 | Pneumatic handle valve rod |
| 143 | FJ04009004676 | Hex socket head cap screw M6*16 | 192 | JZ07001020896 | Pneumatic valve stem cap |
| 145 | FJ08001005319 | O-seal ring Φ68*3.53 | 193 | JZ07001020899 | Pneumatic handle gland |
| 221-182T | JZ09001036722 | Locking cylinder piston U231 | 194 | JZ07001020897 | Pneumatic handle spacer U221 |
| 221-183T | FJ08003036721 | V-seal ring Φ60*Φ70*6 | 195 | FJ08001005325 | O-seal ring Φ7.5*2.65 |
| 221-184 | FJ08001005285 | O-seal ring Φ5.5*2.5 | 196 | FJ04001003759 | Snap Ring 8 |
| 185T | FJ04009004566 | Hex socket head cap screw M6*40 | 197 | EQ10005003297 | Quick coupler G1/8-Φ6 |
| 221-186T | JZ03001036905 | Locking cylinder cover | 221-198 | JZ09001022969 | Hex locking board spring Φ1.5*9*54 |
| 221-187 | FJ08001005293 | O-seal ring Φ60*Φ52*2 | | | |

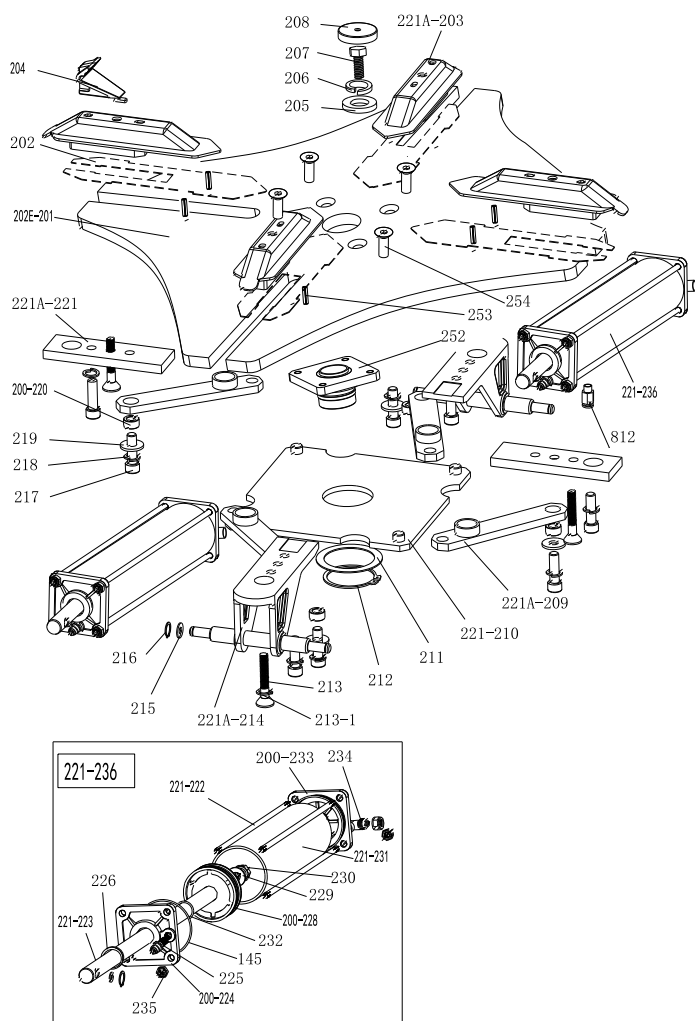

| | | |
|----------|---------------|--|
| 202E-201 | JZ03001049370 | Turntable 720 |
| 202 | JZ03001015580 | Jaw sliding plate(optional) |
| 221A-203 | JZ03001015585 | Jaw cap assembly |
| 204 | JZ09001022893 | Jaw 200 |
| 205 | JZ03001015476 | Big washer |
| 206 | FJ04002003779 | Spring washer Ø16 |
| 207 | FJ04009004828 | Outer hex bolt M16x40x1.5 |
| 208 | JZ07001020860 | Turntable cap |
| 221A-209 | JZ03001015613 | Connection rod assembly 615 |
| 221-210 | JZ03001015456 | Square turntable 615 |
| 211 | JZ03001015457 | Square turntable washer |
| 212 | FJ04001003757 | Snap ring Ø65(shaft) |
| 213 | FJ04006004133 | Hex socket head bolt |
| 213-1 | FJ04002003921 | Teeth locking washer 12*23*1 |
| 221A-214 | JZ03001015835 | Jaw slide guide with pin double holes |
| 215 | FJ04002003813 | Flat washer Ø12X24X2 |
| 216 | FJ04001003737 | Snap ring Ø12(shaft) |
| 217 | FJ04009004809 | Hex socket head bolt M12x85 |
| 218 | FJ04002003917 | Teeth locking washer Ø12x20.5x1 |
| 219 | FJ04002003814 | Flat washer Ø12X30X3 |
| 200-220 | JZ09001015609 | Connection rod nut |
| 221A-221 | JZ03001015767 | Jaw slide guide without pin double holes |
| 221-222 | JZ09001022936 | Threaded connection rod |
| 221-223 | JZ09001022847 | Clamping cylinder piston rod |
| 200-224 | JZ09001022762 | Clamping cylinder cover without handle |
| 225 | EQ11006003389 | Straight union 1/8"-Ø8 |
| 226 | FJ08003005391 | V- seal 20*28*7.5 |
| 227 | FJ08001005319 | O- seal 68*3.55 |
| 200-228 | JZ09001022765 | Clamping cylinder piston Ø75 |
| 229 | FJ04002003813 | Flat washer Ø12X25X2 |
| 230 | FJ04008004495 | Nut M12X7X1.75 |
| 221-231 | JZ09001022857 | Clamping cylinder barrel Ø75*430 |
| 232 | FJ08001005151 | O- seal Ø19.6X2.62 |
| 200-233 | JZ09001022763 | Clamping cylinder cover with handle |
| 234 | EQ11005003366 | Union 1/8"-Ø8 |
| 235 | FJ04008004459 | Self-locking nut M8 |
| 221-236 | JZ06001020248 | Complete clamping cylinder U2098 |
| 252 | JZ03001015477 | Turntable spacer U2098 |
| 253 | FJ06002004972 | Pin Φ5*16 |
| 254 | FJ04006004132 | Screw M12*30 |
| 812 | EQ10005003281 | Quick coupler G1/4-Φ10 |

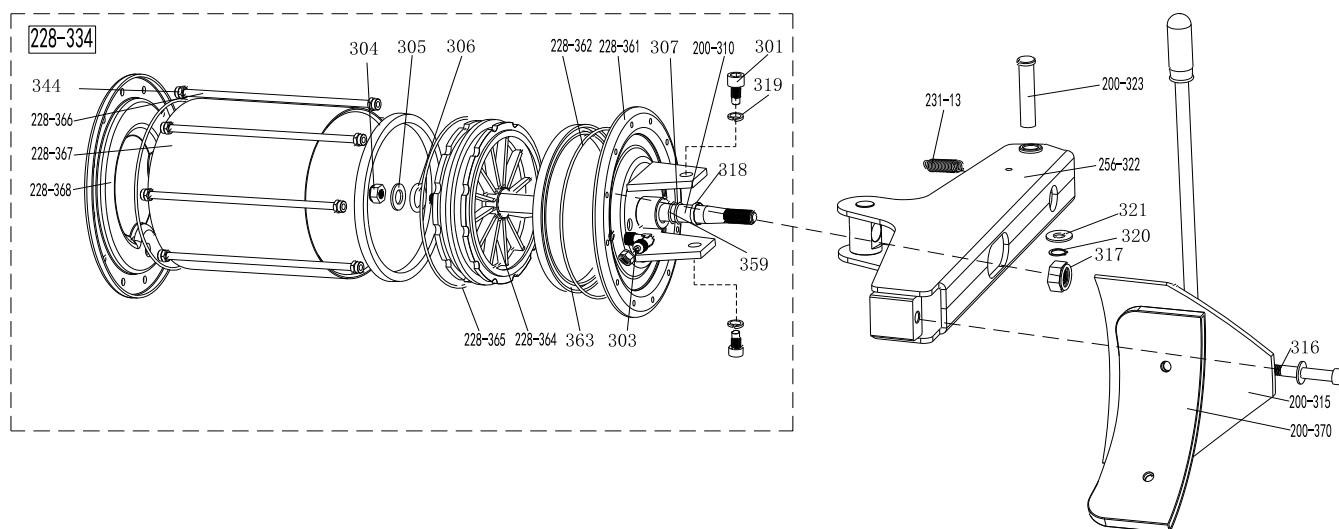

| | | | | | |
|---------|---------------|-------------------------------------|---------|---------------|---|
| 231-13 | JZ09001022723 | Bead breaker arm spring | 359 | FJ08003005391 | V-seal ring $\Phi 20^* \Phi 28^* 7.5$ |
| 301 | JZ09001011179 | Hex socket head bolt M14*30 | 256-322 | JZ08001050333 | Enlarge bead breaker arm 256P |
| 303 | EQ11005003350 | Union (90°) 1/4- $\Phi 8$ | 200-323 | JZ03001015349 | Bead breaker pin |
| 304 | FJ04008004517 | Nut M16*1.5 | 228-334 | JZ06001020266 | Complete bead breaker cylinder U2098 |
| 305 | FJ04002003833 | Flat washer $\Phi 16^* 28^* 2$ | 344 | FJ04008004459 | Self-locking nut |
| 306 | FJ08001005120 | O-seal $\Phi 16^* 2.65$ | 228-361 | JZ03001015383 | Bead breaker cylinder cover assembly |
| 307 | FJ08001005151 | O-seal $\Phi 19.6^* 2.62$ | 228-362 | FJ08001005153 | O-seal $\Phi 195^* 3.1$ |
| 200-310 | JZ09001022746 | Bead breaker cylinder piston rod | 363 | FJ08005005395 | Y-seal $\Phi 184^* \Phi 200^* 12$ |
| 200-315 | JZ03001015790 | Bead breaker shovel assembly | 228-364 | JZ09001022745 | Bead breaker cylinder piston U2098 |
| 316 | FJ04009004613 | Hex socket head bolt M12x90 | 228-365 | FJ08001005135 | O-seal $\Phi 170.8^* 5.33$ |
| 317 | FJ04008004517 | Self-locking nut M16*1.5 | 228-366 | JZ09001022935 | Threaded connection rod |
| 318 | JZ02007039247 | Guide belt | 228-367 | JZ09001022753 | Bead breaker cylinder barrel U2098 |
| 319 | FJ04002003777 | Spring washer $\Phi 14$ | 228-368 | JZ03001015380 | Bead breaker cylinder rear cover |
| 320 | FJ04001003741 | Snap ring $\Phi 16$ | 200-370 | JZ07001020829 | Bead breaker shovel protection cover(optional) |
| 321 | FJ04002003833 | Flat washer 16*28*2 | | | |

| | | | | | |
|---------|---------------|--------------------------------------|---------|---------------|---------------------------------|
| 231-480 | 001022774 | Reverse switch pedal | 200-431 | JZ07001020856 | Reverse switch handle |
| | 001023137 | 5-way valve pedal (right) | 432 | FJ04008004458 | Self-locking nut M6 |
| 228-404 | JZ09001023139 | 5-way valve pedal (left) | 433 | FJ04002003859 | Flat washer Ø3 |
| 405 | FJ04001003737 | Self tapping Ø12 | 434 | FJ04006004306 | Cross head screw M3X18 |
| 406 | FJ04002003813 | Flat washer Ø12 24*2 | 200-435 | JZ03001010560 | Pedal connection rod |
| 407 | FJ04006004326 | Cross head screw M4X30 | 436 | FJ04008004459 | Self-locking nut M8 |
| 408 | FJ04002003874 | Flat washer Ø 4 | 437 | FJ03001010570 | Pedal front shaft |
| 409 | FJ04008004455 | Self-locking nut M4 | 438 | FJ04008004455 | Nut M8 |
| 410 | FJ04008004459 | Self-locking nut M8 | 439 | JZ09001022873 | Pedal twist spring |
| 411 | FJ04002003904 | Flat washer Ø8*17*0.5 | 440 | FJ04009004715 | Hex socket head bolt M8x50 |
| 200-412 | JZ07001020913 | Cam connection rod | 441 | FJ04009004706 | Hex socket head bolt M8x20 |
| 221-433 | JZ09001022884 | Pedal support board | 442 | EQ10004003264 | Quick union 1/8" - Ø 8 |
| 200-414 | JZ09001022872 | Pedal Spring | 443 | EQ10004003262 | Quick union 1/8" - Ø 6 |
| 200-415 | JZ07001020914 | Cam | 445 | EQ10001093242 | Quick T union 1/8-2" Ø 8 |
| 200-416 | JZ09001023109 | Cam washer | 200-449 | JZ07001020920 | 5-way valve barrel (right) |
| 417 | FJ04009004680 | Hex socket head bolt M6x20 | 200-451 | JZ07001020918 | 5-way valve cover |
| 418 | FJ04002003890 | Flat washer Ø6 | 452 | FJ04006004372 | Cross head S 2.9*14 |
| 420 | FJ04006004228 | Cross head self tapping screw 2.9*12 | 453 | EQ04002002955 | Muffler 1/8" 200-455 |
| 200-421 | JZ03001015747 | Cam cover | 200-455 | JZ09001015771 | 5-way valve rod |
| 423 | JZ06001020283 | Complete 5-way valve | 200-456 | JZ07001020919 | 5-way valve rod spacer |
| 200-424 | JZ07001020853 | Reverse switch cover | 439 | FJ08001005087 | O Seal 12*20*3 |
| 425 | FJ04008004511 | Nut M4 | 457 | EQ02005002809 | Throttle valve |
| 200-426 | DD03009001577 | Reverse switch | 465 | JZ12001026441 | Power supply cable |
| 427 | FJ04009004680 | Hex socket head bolt M6x20 | 406 | JZ06001040161 | Complete 5-way valve (tilting) |
| 428 | FJ04002003890 | Flat washer Ø 6X12X1 | 470 | JZ09001022986 | 5-way valve barrel |
| 231-480 | JZ06001020274 | Complete 4-pedals assembly 231 | 471 | JZ07001020918 | 5-way valve cover |
| 429 | FJ04002003874 | Flat washer Ø 4 | 616 | JZ12001026447 | Motor cable |
| 430 | FJ04006004323 | Cross head screw M4*16 | | | |

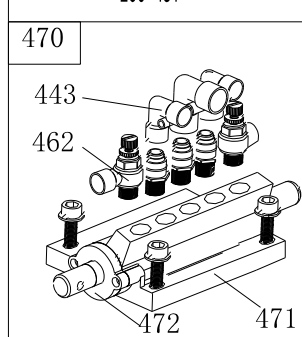
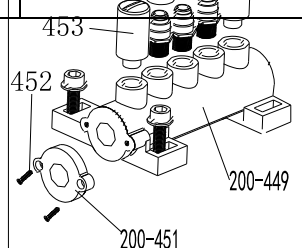
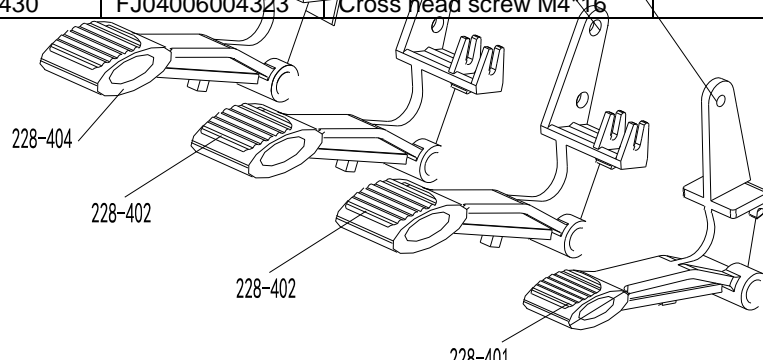

200-526

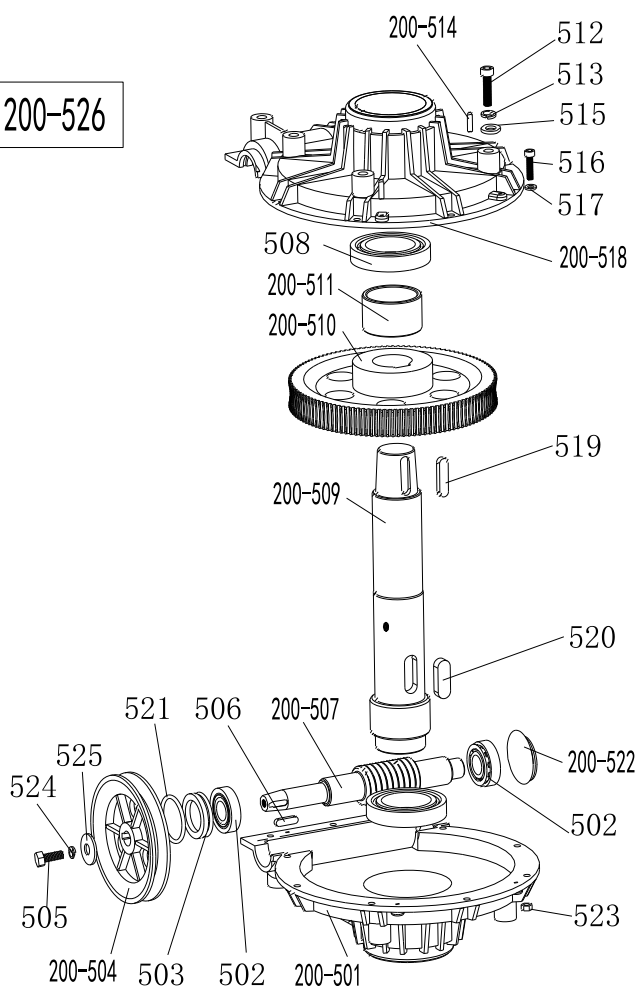

| | | |
|---------|---------------|---------------------------------|
| 200-501 | JZ09001022681 | Gear box lower cover |
| 502 | FJ02010003613 | Bearing |
| 503 | FJ08007005413 | Gear Seal |
| 200-504 | JZ09001023119 | Gear Belt pulley U200 |
| 505 | FJ04009004879 | Outer hex bolt |
| 506 | FJ06001004964 | Key washer |
| 200-507 | JZ09001023118 | Worm rod |
| 508 | FJ02010003623 | Bearing |
| 200-509 | JZ09001023126 | Worm gear shaft |
| 200-510 | JZ09001023250 | Worm gear U200 |
| 200-511 | JZ03001015761 | spacer |
| 512 | FJ04009004779 | Outer hex bolt M10*55 |
| 513 | FJ04002003773 | Flat washer 10 |
| 200-514 | FJ06002005000 | Pin |
| 515 | FJ04002003800 | Flat washer 10*20*2 |
| 516 | FJ04009004680 | hex socket head cap screw M6*20 |
| 517 | FJ04002003892 | Flat washer 6*14*1.2 |
| 200-518 | JZ09001022679 | Gear box upper cover |
| 519 | FJ06001004964 | Key washer 6*20 |
| 520 | FJ06001004963 | Key washer 14*40 |
| 521 | FJ08001005221 | seal ring |
| 200-522 | JZ09001022990 | oil resistant seal |
| 523 | FJ04008004458 | Nut M6 |
| 524 | FJ04002003792 | Flat washer 8 |
| 525 | FJ04002003915 | Flat washer 8*30*3 |
| 200-526 | JZ06001020255 | Complete gear box |

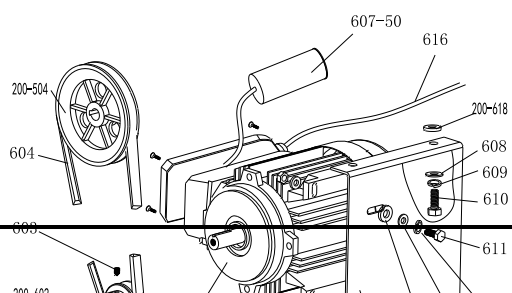

| | | |
|---------|---|------------------|
| 200-504 | JZ09001023119 | Gear Belt pulley |
| 601-MC | Decide order according to customer's requirement: | |

| | | |
|---------|---|----------------------------|
| 601-MY | ___V/___HZ/___KW/___PH For example: 220-240V/50HZ/0.75KW/1PH | |
| 200-602 | JZ09001015421 | Motor Belt pulley |
| 603 | FJ04006004178 | Hex socket head bolt M8x12 |
| 604 | FJ02003003545 | Tyre changer belt A-28 |
| 605 | FJ04009004889 | Outer hex bolt M8X65 |
| 606 | FJ04002003915 | Flat washer Ø8X30X3 |
| 607-80 | DD04009001964 | Capacitor 80µf,110V |
| 607-50 | DD04009001883 | Capacitor 50µf,220V |
| 608 | FJ04002003800 | Flat washer Ø10X20X2 |
| 609 | FJ04002003773 | Spring washer Ø10 |
| 610 | FJ04009004772 | Outer hex bolt M10X30 |
| 611 | FJ04009004883 | Outer hex bolt M8X35 |
| 612 | FJ04008004515 | Nut M8 |
| 613 | FJ04002003910 | Flat washer φ8X22X2 |
| 614 | JZ09001022782 | Motor rubber washer |
| 200-615 | JZ03001015423 | Motor support |
| 616 | JZ12001026447 | Motor cable 5x1.0 |
| 617 | FJ04002003792 | Spring washer φ8 |
| 200-618 | JZ09001022782 | Motor rubber buffer |

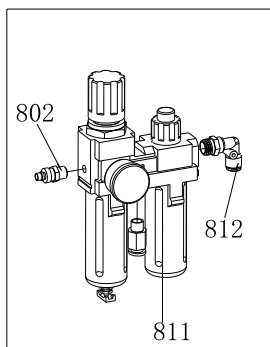

| | | |
|-----|--------------------------------|------------------------|
| 802 | Decide by Type of Quick nozzle | Quick nozzle |
| 811 | EQ03001002902 | Filter AW+AL3300 |
| 812 | EQ11005003350 | Quick coupler G1/4- Ø8 |

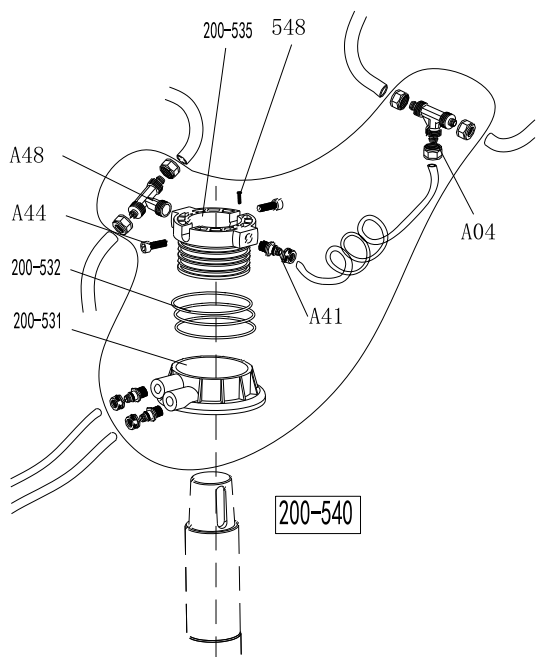

| | | |
|---------|---------------|----------------------------------|
| A04 | EQ11002003333 | Quick coupler |
| A44 | FJ04009004676 | hex socket head cap screw |
| A48 | EQ11002003340 | Quick coupler |
| 200-531 | JZ02007015872 | Rotating valve casing 200 |
| 200-532 | FJ08001005300 | seal ring |
| 200-535 | JZ02007015676 | Rotating valve mandrel |
| 537 | CF01002000936 | Flexible air hose |
| A41 | EQ11006003389 | Quick coupler |
| 548 | FJ04006004060 | screw |
| 200-540 | JZ06001020249 | Complete Rotating valve, plastic |

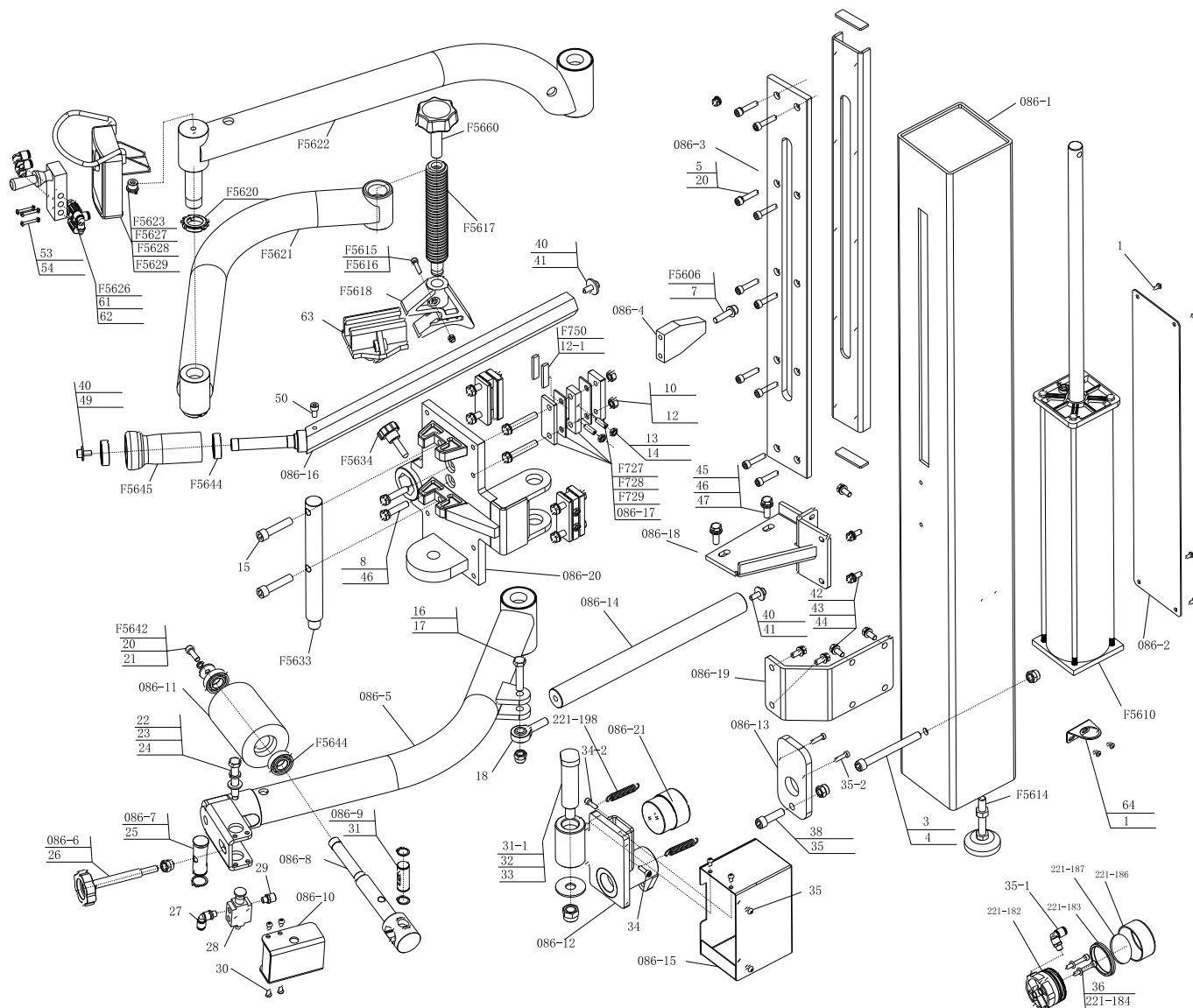

| | | | | | |
|--------|---------------|----------------------------------|------|---------------|----------------------------------|
| 086-1 | JZ08007047716 | Column assembly | 34-2 | JZ09001022756 | Spring pin |
| 086-2 | JZ08001047725 | Column back cover 086 | 35 | FJ04006004114 | Allen head screw M6*10 |
| 086-3 | JZ03001048144 | Frame | 35-1 | EQ10004003262 | Quick coupler G1/8-f6 |
| 086-4 | JZ08001048166 | Connecting piece | 36 | FJ04009004566 | hex socket head cap screw M6*40 |
| 086-5 | JZ08001048118 | rod assembly | 38 | FJ04009004607 | hex socket head cap screw M12*40 |
| 086-6 | JZ07001048105 | Adjust handle | 40 | FJ04009004706 | hex socket head cap screw M8*20 |
| 086-7 | JZ03001048099 | rod | 41 | FJ04002003915 | Flat washer 8*30*3 |
| 086-8 | JZ03001047878 | Tire hinges | 42 | FJ04009004877 | Outer hex bolt M8*20 |
| 086-9 | JZ03001047814 | Position the hinge | 43 | FJ04002003792 | Spring washer 8 |
| 086-10 | JZ08001048080 | panel assembly | 44 | FJ04002003910 | Flat washer 8*22*2 |
| 086-11 | JZ02007047903 | Tire pressing cover | 45 | FJ04009004770 | Outer hex bolt M10*25 |
| 086-12 | JZ08001047973 | cylinder support | 46 | FJ04002003773 | Spring washer 10 |
| 086-13 | JZ03001047925 | rod | 47 | FJ04002003800 | Flat washer 10*20*2 |
| 086-14 | JZ09001047986 | Lock the round rod | 49 | FJ04002003792 | Flat washer |
| 086-15 | JZ08001047945 | Cover | 50 | FJ04009004877 | Outer hex bolt |
| 086-16 | JZ03001047757 | Tire pressing rod assembly | 53 | FJ04006004200 | screw M4*30 |
| 086-17 | JZ03001015670 | Friction external pressure plate | 54 | FJ04008004510 | Hex nut M4 |
| 086-18 | JZ08001048154 | Bracket assembly right | 61 | EQ04002002955 | Muffler G1/8 |

| | | | | | |
|--------|---------------|-----------------------------------|---------|---------------|-------------------------------------|
| 086-19 | JZ08001048162 | Connecting piece | 62 | EQ10004003254 | Quick coupler G1/4-R6 |
| 086-20 | JZ02007047734 | Arm seat assembly | 63 | JZ07001020927 | Tire pressing head(bottom) |
| 086-21 | JZ04001018100 | Lock cylinder assembly elbow | 64 | JZ03001015829 | Support for Oil fog maker 203 |
| 1 | FJ04006004408 | screw M5*6 | F5606 | FJ04009004586 | hex socket head cap screw M10*40 |
| 3 | FJ04009047764 | hex socket head cap screw M12*160 | F5610 | JZ09001023066 | Raise-fall cylinder 056 |
| 4 | FJ04008004445 | Self-locking nut M12 | F5614 | JZ09001023207 | Support feet |
| 5 | FJ04009004706 | hex socket head cap screw M8*20 | F5615 | FJ04009004685 | hex socket head cap screw M6*30 |
| 7 | FJ04002003800 | Flat washer 10*20*2 | F5616 | FJ04008004458 | Self-locking nut M6 |
| 8 | FJ04009004768 | Outer hex bolt M10*20 | F5617 | JZ03001015814 | Tire pressing head rotating shaft |
| 10 | FJ04009004747 | Hexagon bolt half tooth M10*80 | F5618 | JZ07001020926 | Tire pressing head (upper) |
| 12 | FJ04008004444 | Self-locking nut M10 | F5620 | FJ04008004448 | Self-locking nut M16 |
| 12-1 | JZ03001015668 | Friction sheet top block | F5621 | JZ08001021139 | Rotating arm assembly 2 |
| 13 | FJ04006004168 | Allen flat end set screw M8*25 | F5622 | JZ08001021141 | Rotating arm rod assembly |
| 14 | FJ04008004515 | Hex nut M8 | F5623 | JZ08001049888 | Control panel assembly |
| 15 | FJ04009004607 | hex socket head cap screw M12*40 | F5626 | EQ02011002888 | 3-position 5-way manual wrench |
| 16 | FJ04009004752 | Outer hex bolt M12*60 | F5627 | JZ07001049894 | Control valve protection cover |
| 17 | FJ04008004445 | Self-locking nut M12 | F5628 | FJ04009004770 | Outer hex bolt M10*25 |
| 18 | FJ02010048068 | Bearing | F5629 | FJ04002003773 | Flat washer 10 |
| 20 | FJ04002003792 | Spring washer 8 | F5633 | JZ03001015849 | shaft |
| 21 | FJ04002003915 | Flat washer 8*30*3 | F5634 | JZ09001023132 | Pentagon handle M10*30 |
| 22 | FJ04009004806 | Outer hex bolt M12*65 | F5642 | FJ04009004706 | hex socket head cap screw M8*20 |
| 23 | FJ04002003775 | Spring washer 12 | F5645 | JZ02007047903 | Tire pressing cover |
| 24 | FJ04002003814 | Flat washer 12*30*3 | F5644 | FJ02010003601 | Bearing |
| 25 | FJ04001003747 | Snap Ring 25 | F5660 | JZ07001020911 | Adjust handle |
| 26 | FJ04008004444 | Self-locking nut M10 | F727 | JZ03001015667 | Friction internal compression plate |
| 27 | EQ10004003262 | Quick coupler | F728 | CF03003001071 | Guide belt 30*2.5 |
| 28 | EQ02012002889 | Hand valve | F729 | JZ03001015669 | Friction plate isolation block |
| 29 | EQ10005003297 | Quick coupler | F750 | CF03003001069 | Guide belt 11*2.5 |
| 30 | FJ04006004114 | screw | 221-182 | JZ09001023098 | Lock cylinder piston U221 |
| 31 | FJ04001003743 | Snap Ring 20 | 221-183 | FJ08003005389 | seal ring 50*60*6.5 |
| 31-1 | JZ03001015837 | Pressing arm pin (right) | 221-184 | FJ08001005285 | seal ring 5.5*2.5 |
| 32 | JZ03001015476 | Big washer | 221-186 | JZ03001015728 | Lock cylinder head U221 |
| 33 | FJ04008004448 | Self-locking nut M16 | 221-187 | FJ08001005293 | seal ring 52*2 |
| 34 | FJ04009004676 | hex socket head cap screw M6*20 | 221-198 | JZ09001022969 | Hex locking board spring |

19. Circuit diagram:

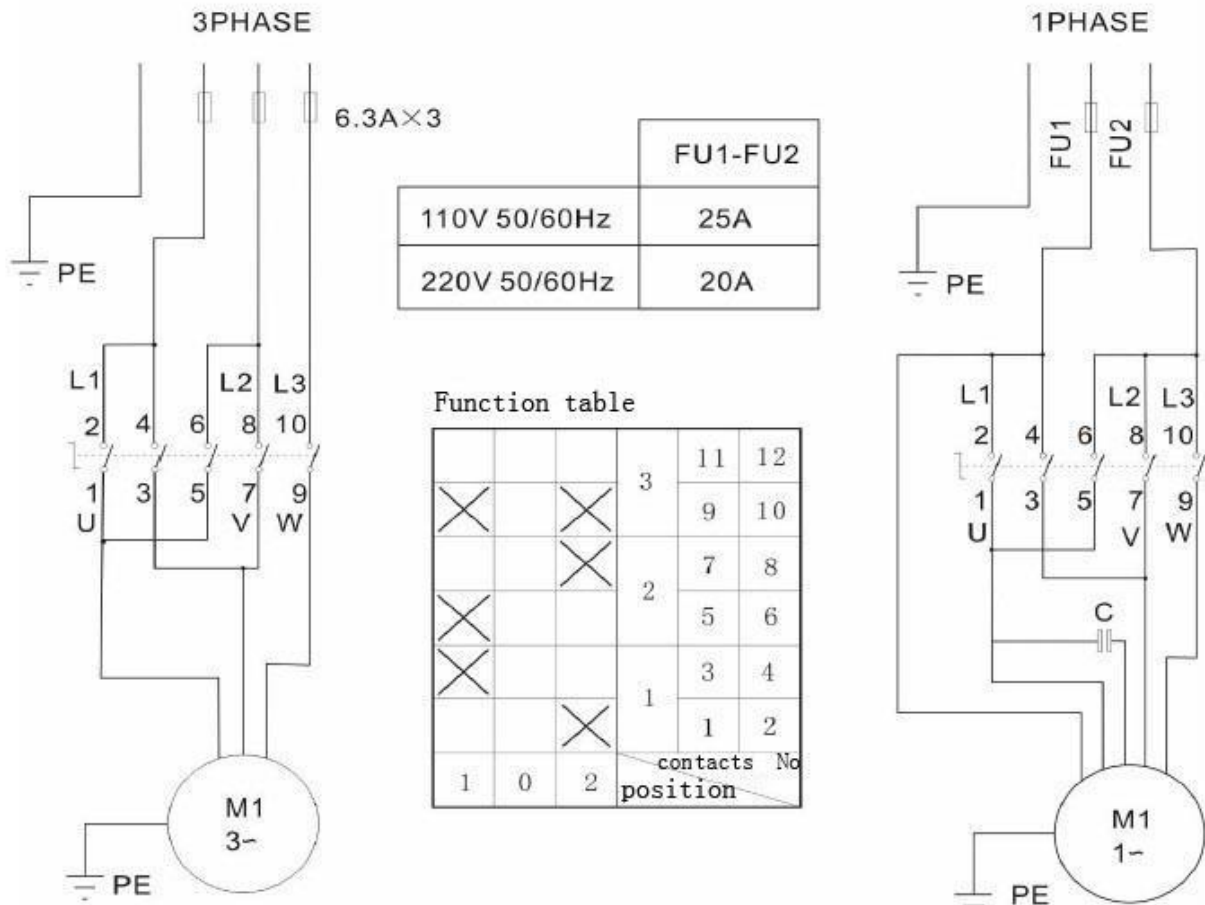

20. Pneumatic drawing:

