

说明书材质要求：80g 双胶纸	说明书成品尺寸： <b>105*143mm</b>
第一： <b>专色用6级防晒油墨</b>	第二：特别注意： 1.印刷时看样请参考我司提供的实物样品颜色。不得偏色
	<div style="display: flex; align-items: center;"> <div style="width: 15px; height: 15px; background-color: #000080; margin-right: 5px;"></div> Pantone 286C         </div> <div style="display: flex; align-items: center; margin-top: 5px;"> <div style="width: 15px; height: 15px; background-color: #000000; margin-right: 5px;"></div> Black (两色印刷)         </div>
折叠方式： <b>风琴折</b> (20°以下 前风琴折)	备注：

特别注意：此页内容不印刷

<p>风琴折+对折 页面顺序</p> <p style="text-align: center; color: red;">16P 页面顺序</p> <table border="1" style="margin: 10px auto; border-collapse: collapse; text-align: center;"> <tr><td>9</td><td>10</td><td>11</td><td>封面</td></tr> <tr><td>12</td><td>13</td><td>14</td><td>封底</td></tr> </table> <table border="1" style="margin: 10px auto; border-collapse: collapse; text-align: center;"> <tr><td>1</td><td>2</td><td>3</td><td>4</td></tr> <tr><td>5</td><td>6</td><td>7</td><td>8</td></tr> </table>	9	10	11	封面	12	13	14	封底	1	2	3	4	5	6	7	8	<p style="text-align: center; color: red;">20P 页面顺序</p> <table border="1" style="margin: 10px auto; border-collapse: collapse; text-align: center;"> <tr><td>11</td><td>12</td><td>13</td><td>14</td><td>封面</td></tr> <tr><td>15</td><td>16</td><td>17</td><td>18</td><td>封底</td></tr> </table> <table border="1" style="margin: 10px auto; border-collapse: collapse; text-align: center;"> <tr><td>1</td><td>2</td><td>3</td><td>4</td><td>5</td></tr> <tr><td>6</td><td>7</td><td>8</td><td>9</td><td>10</td></tr> </table>	11	12	13	14	封面	15	16	17	18	封底	1	2	3	4	5	6	7	8	9	10
9	10	11	封面																																		
12	13	14	封底																																		
1	2	3	4																																		
5	6	7	8																																		
11	12	13	14	封面																																	
15	16	17	18	封底																																	
1	2	3	4	5																																	
6	7	8	9	10																																	

更改记录	1. 新产品		1. 改新版式 2. 自制工厂			
	0323.W01	2023.03.17	Athena	0523.W02	2023.05.26	YJJ
	版本号	日期	设计师	版本号	日期	设计师

## PRODUCT MANUAL

# KNAPSACK SPRAYER

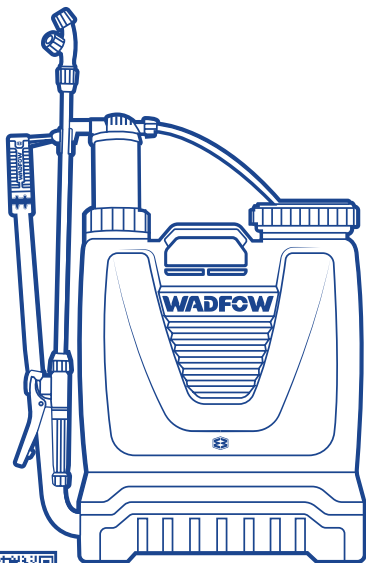

SCAN FOR VIDEO

WKS1516 WKS1520

# WADFOW



WADFOW

## Original Instructions

**GENERAL SAFETY WARNINGS****⚠ Warning!**

**This sprayer is not to be used with solvents, caustic chemicals, acids or concrete curing products.**

**Do not use flammables in this sprayer.**

Read Product Manual completely before operating this sprayer.

Always refer to mixing and safety instructions as specified by chemical supplier.

Always wear protective gloves, clothing and safety goggles whilst preparing, operating and cleaning this sprayer.





Prior to use inspect hose and all those connections. A damaged hose, or loose hose connection can result in un-intended exposure to the pressurized chemical, resulting in serious injury or property damage.

Do not lift or carry sprayer by the hose, or wand extension. Lift by tank handle or carry straps only.

Avoid spraying in windy conditions to prevent drift of chemicals.

Keep the sprayer and all chemicals out of the reach of children.

**THE SYMBOLS IN INSTRUCTION MANUAL**

	Read the instruction manual before using.
	Safety alert. Please only use the accessories supported by the manufacturer.
	Wear safety glasses, hearing protection and dust mask.
	Waste electrical products should not be disposed of with household waste. Please recycle where facilities exist. Check with your Local Authority or retailer for recycling advice.

## SPECIFICATIONS

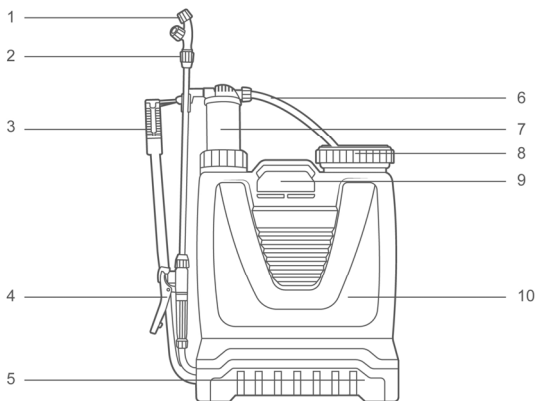

### Components list

- |  |                  |
|--|------------------|
| 1. Spray nozzle (3 options – Single adjustable, double adjustable and fan) | 5. Tank base     |
| 2. Pump lever brace  | 6. Hose          |
| 3. Pump lever handle   | 7. Pump assembly |
| 4. Trigger   | 8. Filling cap   |
|  | 9. Carry straps  |
|  | 10. Tank         |

### Technical specifications

Model No.	WKS1516	WKS1520
Net capacity	up to 16L	up to 20L
Work pressure	1.5-4.5bar	1.5-4.5bar
Unloaded weight	3.3kg	3.5kg

## OPERATION PICTURE

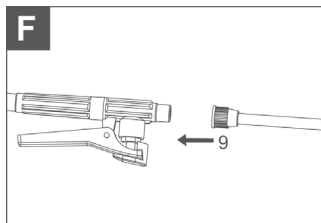
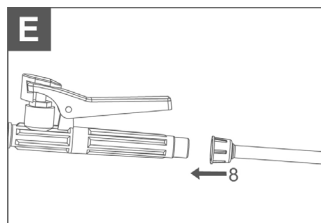
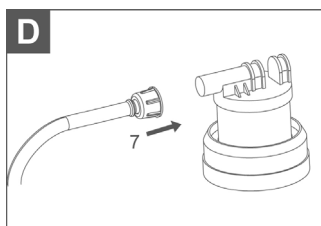
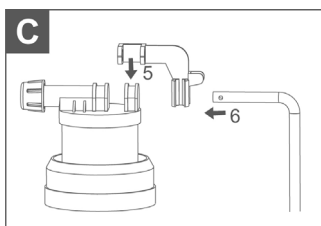
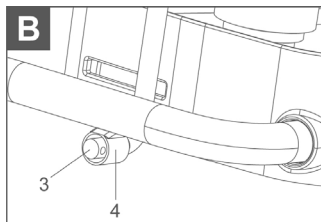
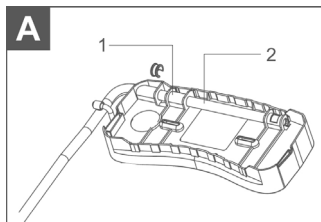

## OPERATION

1. Fit the handle and lance retaining clip to the top of the air chamber. (see Dia A)
2. Insert the long end of the connecting rod through the hole in the top of the air chamber and retaining clip. (see Dia A)
3. Secure the connecting rod to the handle with the split pin and washer. (see Dia B)
4. Insert the handle into the hole in the tank base. (see Dia B)
5. Fit the short end of the connecting rod through the hole in the handle. (see Dia C)
6. Secure the connecting rod in position with the split pin. Fit the attachment clip over the end of the handle and between the flanges of the green tank base. (see Dia C)
7. Attach one end of the spray hose to the fitting on the air chamber. (see Dia D)
8. Attach the other end of the spray hose to the inlet fitting of the trigger valve (see illustration for correct orientation). (see Dia E)
9. Attach the spray lance to the outlet of the trigger valve. (see Dia F)

### Operating Instructions

1. Before filling always check that the sprayer's shoulder straps are correctly fitted and adjusted so that the sprayer sits comfortably on your back.
2. Fit the appropriate spray nozzle for the spray pattern required.
3. Unscrew the filler cap but do not remove the internal strainer.
4. All tank with required liquid to re-quired level. Do not exceed the "MAX" fill level on tank.

5. Replace the filler cap and tighten. Ensure all other fittings are tightened before use.
6. Pressurize the sprayer by pumping lever handle 6-8 times. Stop pumping if becomes difficult to pump as you do not want to over pressurize.
7. Start spraying by holding down the trigger. For continuous spraying the trigger can be locked.
8. Continue operating the pump handle using a steady motion to maintain pressure in the sprayer pump whilst spraying.

## **Cleaning Instructions**

For sprayer longevity please follow these instructions after every use.

Release pressure via trigger.

Empty any leftover contents in a safe manner.

### **Note:**

**Even if tank is empty there may be residual liquid in pump chamber. Empty chamber by locking trigger and continuously pumping handle a few times.**

All tank 1/4 full with clean water.

Pressurize and then hold trigger down to empty entire tank via nozzle.

Thoroughly rinse all components with clean water.

Periodically clean the inner filter inside trigger to avoid blockages. This can be done by unscrewing hose from Trigger and pulling out the filter from trigger handle. Rinse under clean water and reattach to trigger handle, tightening firmly.

## **Storage**

Do not store with contents in tank. This will destroy your sprayer mechanism. Do not store pressurized. Lift safety valve to release pressure.

Store out of sunlight.

## MAINTENANCE&MALFUNCTIONS

Trouble	Check	Remedy
Poor spray pattern or sprayer does not spray. <b>Note: Blockages are the most common reason for a sprayer failure.</b>	Check nozzle for blockage	Remove nozzle and clean
	Inspect trigger, lance, hose and pickup tube for blockage	Remove and clear block-ages from trigger, lance, hose and pickup tube Remove Inline filter in trigger and clean
Air or liquid leak around pump assembly	Dirt on pump gasket or cylinder	Clean gasket and surface of pump cylinder and tank where gasket seats
	Check gasket for wear and damage	Replace gasket if worn or damaged
Sprayer does not pressurize	Check pressure chamber installed correctly	Reinstall pressure cham-bar
	Check O-ring & gaskets	Replace O-ring & gaskets if missing or damaged
Hose leaks at tank or trigger	Is hose loose?	Tighten hose nuts
	Check hose for cracks or holes	Replace hos
	Check hose fittings for damage	Replace O-rings or fitting
Nozzle tip is leaking	Check Nozzle tip is tight	Tighten nozzle tip
	Check Nozzle tip for dam-age	Replace nozzle tip
	Is O-ring missing or dam-aged	Replace O-ring
Sprayer starts to spray when pumping	Trigger lock engaged	Remove trigger lock
	Dirt around trigger	Clean trigger





KEYWAY TECHNOLOGY  
(NANTONG) CO., LTD

[www.wadfow.com](http://www.wadfow.com)

MADE IN CHINA 0523.W02